

Sheraton New Orleans
New Orleans, Louisiana
October 7–10, 2008



FINAL PROGRAM

URISA 2008 Annual Conference & Exposition

Spatially Enabling The Enterprise

GISCI points earned
for attending one
workshop and this
conference =
.5 Education Points

WELCOME TO URISA'S 2008 ANNUAL CONFERENCE AND EXPOSITION!

Welcome to New Orleans and URISA's 2008 Annual Conference & Exposition

This week promises to be a high-energy event with many opportunities for networking and learning. The Conference Committee has put together a great program packed with a variety of educational, interactive, and fun activities. The conference offerings are of the highest quality with considerable time spent, organizing, debating, and identifying great content.

This year's conference theme, Spatially Enabling the Enterprise, stresses how GIS is integrating with major IT systems. To illustrate this theme we have brought together a wide variety of presentations that highlight how GIS supports critical business applications from almost every conceivable discipline and profession.

After a full day of workshops, the Annual Conference & Exposition will begin with an informative Opening Session and Keynote Speaker. We are proud to present David Gisclair of the Louisiana Oil Spill Coordinator's Office as our Keynote speaker to kick things off. This is followed by two and one-half days of quality presentations by industry leaders presenting what is going on in the GIS world today. The Exposition will allow vendors to show you their latest developments, while providing a venue to meet new people and catch up with old friends and colleagues. This year we have redesigned the Awards and Recognition Ceremony into a format that allows both audience and recipients a more comfortable atmosphere and pace by way of an Awards Breakfast. The Conference Social Event is a short walk from the Sheraton Hotel at Pat O's on the River, in the Jax Millhouse, with live entertainment.

I encourage you to drop in on one of the many URISA Committee meetings taking place during the conference. Stop anyone wearing a Committee Member, Board of Directors or Staff ribbon on their name badge to learn more about volunteer opportunities. I've expanded my professional network and have developed my leadership skills through my participation on URISA Committees, in addition to making life-long friends. I encourage you to get involved!

I hope you enjoy New Orleans and have a great time at the conference!

Sincerely
David Dubauskas M.Sc.–2008 Conference Chair
Strathcona County, Alberta



Table of Contents

Program Tracks	4
Conference Bytes	6
URISA Leadership.....	8
Awards	9
Tuesday Program	15
Wednesday Program.....	18
Conference-At-A-Glance	22
Thursday Program	27
Friday Program	33
Exhibit Hall Directory.....	36
Exhibitor Floor Plan	40
Hotel Floor Plan.....	41
Speaker Index.....	42

Join us in congratulating Dave Dubauskas as he recently accepted a position as City Manager of Fort Saskatchewan, Alberta. Dave's contributions to this conference have been so important, but unfortunately he was unable to attend this week. He's with us in spirit though! Thanks for everything Dave!

Conference Summary

Monday, October 6, 2008

URISA Board of Directors Meeting
URISA Chapter Leaders' Forum

Tuesday, October 7, 2008

Workshops
First-Time Attendee Orientation Meeting
User Group Meetings

Wednesday, October 8, 2008

Welcome & Opening Session
Keynote Address—David Gisclair, Louisiana Oil Spill
Coordinator's Office, Baton Rouge, LA
Educational Sessions
Exhibits
Roundtable Discussion Luncheon
Networking Reception

Thursday, October 9, 2008

Awards Breakfast
Educational Sessions
Exhibits
All-Conference Social Event at Pat O's

Friday, October 10, 2008

Educational Sessions
General Session & Closing Keynote—Grass Roots GIS in
the Recovery of New Orleans
URISA Annual Business Meeting
Rebuild New Orleans Charity Event

Saturday, October 11, 2008

URISA Board of Directors Meeting

2008 URISA Annual Conference & Exposition Conference Committee

Conference Chair - David Dubauskas, Alberta Capital Regional Alliance, Sherwood Park, Alberta Canada

Program Chair - Mike Lovett, GISP, Camp Dresser & McKee Inc., Maitland, Florida

Associate Program Chair - Danielle Ayan, GISP, Georgia Institute of Technology, Atlanta, Georgia

Program Committee Members

Carl Anderson, Fulton County, Atlanta, Georgia
Clare Brown, GISP, Montgomery Watson Harza, New Orleans, Louisiana
Kathrine Cargo, GISP, Orleans Parish Communications District, New Orleans, Louisiana
Tom Conry, Fairfax County, Fairfax, Virginia
Randy Fusaro, US Census Bureau, Washington, DC
Winchester Jordan, Lafayette Parish Assessor's Office, Lafayette, Louisiana
Alex Hepp, Pictometry International, Rochester, New York
Wansoo Im, Vertices, New Brunswick, New Jersey
Al Little, City of Hamilton, Ontario, Canada
Lisa Lubeley, GISP, Dudek Inc., Encinitas, California
Twyla McDermott, City of Charlotte, Charlotte, North Carolina
Kim McDonough, GISP, Tennessee Department of Transportation, Nashville, Tennessee
Hilary Perkins, GISP AICP, East-West Gateway Coordinating Council, St Louis, Missouri
Milo Robinson, Federal Geographic Data Committee, Reston, Virginia
Mark Sievers, Sievers & Associates, Altamonte Springs, Florida
Ken Sipos, City of Philadelphia, Pennsylvania
Cy Smith, GISP, State of Oregon DAS/Geospatial Enterprise Office, Salem, Oregon
Karen Stewart, GISP, ESRI Canada, Ltd., Vancouver, British Columbia Canada
Mohammed Tariq, GISP, Peak Technology Solutions Inc., Washington, DC
Michael Waltuch, ESRI, New York, New York
Tobias Wolf, GISP, HDR Inc, San Diego, California

Workshop Chairs

Michael Lovett, GISP, CDM, Maitland, FL
Keri Brennan, GISP, The Schneider Corporation, Indianapolis, IN
David Lanter, GISP, CDM, Voorhees, NJ

ESIG Award Chair

Gary Hunter, University of Melbourne Department of Geomatics, Australia



PROGRAM TRACKS

The educational program has been organized into several important program tracks described below. Attendees may choose to concentrate on sessions within one or two tracks, or jump between sessions in multiple tracks. This 'do-it-yourself' educational experience allows you to tailor fit your conference experience to your specific needs!

Cross-Jurisdictional Collaboration

Collaboration in one form or another is a fundamental component of every successful GIS implementation. True partnerships, where all partners benefit equally, lead to ongoing successes with every aspect of a program, from data sharing to enterprise application and architecture development to shared services. Participants in this track will learn about collaboration techniques and help define new approaches for developing and managing long-term partnerships.

Management & Professional Development

Spatial information professionals often have unique experience, training, and education credentials that are mostly technical. Yet, your continuing professional advancement will depend on your ability to communicate with decision-makers, the social networks you build, and the ongoing education you receive throughout your career. To become an authority and a leader, both students and specialists alike must develop a wide-ranging set of skills. This track was formed to address a number of issues pertinent to the image and professional development path of the geospatial technologies professional in today's working world. An essential goal of this track is to provide an interactive forum for URISA to help define the necessary steps and the available resources to develop an insightful geospatial professional - someone capable of functioning at all levels as an indispensable member of a management team.

3D GIS

The integration of GIS and IT tools in business applications continues to grow. Increasingly, businesses depend more heavily on their ability to perform a variety of qualitative and quantitative analytical tasks in real world, three-dimensional contexts. The sessions in this track will highlight new and innovative 3D tools, data, and methods that facilitate automated data mapping, reporting, data capture and validation, modeling, and visualization. Bring your world to your desktop!

Geospatially Enabled Enterprise

Geospatial technologies are now considered mainstream components within the overall enterprise IT framework and are increasingly used for a wide range of business process automation. Key considerations toward implementing geospatial enterprise solutions will be examined. Integrating technologies such as SOA, open frameworks, web portals and overcoming data ownership issues are all critical components that will be discussed. The importance of enterprise addressing systems and standards are emphasized. Examples of integrating legacy property/tax data, utility field data collection/inspection and adding geospatial representation to document management systems will be presented. See how the development and implementation of a Capital Improvement Plan (CIP) involves collaboration and information synthesis from multiple lines of business within an agency from budgeting and finance to construction project management. Listen to case studies on geospatial enterprise solutions at the local and state/provincial levels.

Emergency Management & Homeland Security

The degree to which communities are (or are not) prepared to respond effectively in the event of a disaster or emergency situation has raised many issues. Natural disasters such as wildfires and flooding, and man-made emergencies such as collapsing infrastructure all require a coordinated, prepared response. Attend this track and hear how GIS technology is incorporated in different phases of emergency response and management. Featured in this track are presentations on GIS in Public Health, methods of data preparation and dissemination, case studies, and lessons learned from past disasters.

Public Participation GIS (PPGIS)

As stakeholders from local to international levels increasingly rely on spatial data for collective decision-making, public participation and GIS have become ever more closely linked. This program track highlights new developments in Public Participation GIS for a range of applications including planning, smart-growth, public health, disaster response, and environmental management at a variety of scales.

Data Acquisition & Conversion

A GIS is a collection of hardware, software, and data. Without the data, a geographic information system doesn't exist. With the lack of data, there are no inputs on which to provide analyses for support of decision-making. Data that is not verified and maintained is as bad as not having data, as the results may not be very useful for making decisions. Data that is input in a non-structured manner can cost you time and money. This track covers a wide range of topics that will challenge the practitioner in a number of areas such as: standards, data models, verification and maintenance, and metadata, along with more specific data.

Natural Resources & Environment

The stewardship of our environment discusses the interplay of economically sound development, resource management, education and research to preserve and maintain our natural resources, using remote sensing and available GIS tools.

Infrastructure

Infrastructure is part of our everyday lives. We all expect good roads, clean drinking water and reliable electricity to light our homes and businesses. It is one of those things that everyone takes for granted. Yet, it is the infrastructure that keeps our lives going. Everything from commerce to sewerage treatment depends on infrastructure. It is the roads, pipes, ditches, and the wires that make it possible for anything to get done. Infrastructure data is as diverse as it is necessary. More and more jurisdictions are using GIS technology as part of their business to manage various components of infrastructure. There are still cases where it is taken for granted and is often neglected as a GIS framework layer. In many cases, infrastructure data exists as memories in someone's mind or as a stack of plans in a file drawer. These sessions will help to reveal variety methodologies for creating and then effectively utilizing GIS in managing and maintaining infrastructure data.

Interactive & Problem Solving Track

Part of attending a conference is finding ways to apply solutions to your every day, real-world problems. This track will help you identify ways to implement solutions through group discussion as well as polling panels of industry experts.

Registration Hours

Thanks to ESRI for sponsoring the conference tote bags!

Monday, October 6	1:00–5:00 PM
Tuesday, October 7	7:00 AM–6:00 PM
Wednesday, October 8	7:00 AM–5:00 PM
Thursday, October 9	7:00 AM–5:00 PM
Friday, October 10	7:30 AM–12:00 PM

A Special Thank You to the Following Sponsors of URISA's Annual Conference & Exposition:



CDM

EnerGov Solutions, LLC

FLURISA – The Florida Chapter of URISA

Georgia Chapter of URISA

iLOOKABOUT Corp

Ontario, Canada Chapter of URISA

PBS&J

TeachMeGIS

Washington State Chapter of URISA

The URISA Conference welcomes participants of any sex, age, race, color, nationality, sexual orientation and ethnic origin. It does not discriminate on the basis of sex, age, race, color, nationality, sexual orientation or ethnic origin in the administration of its policies. The URISA conference complies with the American with Disabilities Act. Educational programs planned and presented by URISA provide attendees with relevant and rewarding continuing education experience. However, neither the content (whether written or oral) of any course, seminar or other presentation, nor the use of a specific product in conjunction therewith, nor the exhibition of any materials by any party coincident with the educational event, should be construed as indicating endorsement or approval of the views presented, the products used, or the materials exhibited by URISA, or by its committees, Special Interest Groups, Chapters or other commissions.

What is URISA?

The Urban and Regional Information Systems Association (URISA) is a nonprofit association of professionals using Geographic Information Systems (GIS) and other information technologies to solve challenges in state/provincial, regional and local government agencies. URISA is considered to be the premier organization for the use and integration of spatial information technology to improve the quality of life in urban and regional environments. Through its international, national and local chapter operations, URISA serves nearly 7,000 professionals. For more information about URISA, visit www.urisa.org

CONFERENCE BYTES

Exhibit Hall

Complementing the educational presentations and invaluable discussions at the 2008 Annual Conference & Exposition, is the opportunity to find solutions to your GIS needs in the Exhibit Hall. See what's new, collect information to make wise purchasing decisions, compare products and services, participate in hands-on demonstrations, and get answers to your questions. For a complete list of exhibitors, go to page 36.

Exhibit Hall Hours

Wednesday, October 8	10:00 AM–7:00 PM
Thursday, October 9	10:00 AM–4:00 PM

Conference Proceedings—Sponsored by ESRI

The 2008 Annual Conference Proceedings will be available approximately 1 month after the conference, in order to gather as many up-to-date papers as possible for your future reference.

Internet Access

An Internet Café will be available for conference attendees in the exhibit hall during regular exhibit hall hours.

Charity Event

If you wish to participate in the Friday afternoon charity event and did not pre-register, stop by the registration desk to do so!

Meeting Schedule

Several URISA committees have scheduled meetings during the conference. For impromptu meetings, please visit the registration desk to check meeting room availability and schedule.

URISA Board of Directors—

Monday, October 6, 8:30 AM–4:00 PM
Room: Nottaway–4th floor

URISA Chapter Leaders Forum—

Monday, October 6, 1:00 PM–4:00 PM
Room: Oak Alley–4th floor

URISA Board & Chapter Leaders Reception/Meeting—

Monday, October 6, 4:00 PM–5:00 PM
Room: Oak Alley–4th floor

Workshop Development Committee, Workshop Instructors & URISA Leadership Academy Joint Meeting

Tuesday, October 7, 6:00 PM–7:00 PM
Room: Grand Chenier–5th floor

URISA Past Presidents Breakfast Meeting—

Wednesday, October 8, 7:30 AM–8:30 AM
Room: Grand Chenier–5th floor

ESIG Committee—

Wednesday, October 8, 12:15PM–1:15PM
Grab your box lunch and head to the meeting!
Room: Oakley–4th floor

Publications, Website & Student Paper Committee—

Thursday, October 9, 10:30 AM–11:30 AM
Room: Oakley–4th floor

URISA Policy Advisory Committee—

Thursday, October 9–3:00 PM–4:00 PM
Room: Oakley–4th floor

URISA Annual Conference Committee—

Friday, October 10, 7:30 AM–8:30 AM
Room: Oakley–4th floor

URISA Leadership Academy Committee—

Friday, October 10, 8:30 AM–10:00 AM
Room: Oakley–4th floor

URISA Board of Directors—

Saturday, October 11, 8:30 AM–12:00 NOON
Room: Cornet Room–8th floor

GIS Certification Institute –
www.gisci.org



Interested in finding out more about GIS Professional Certification? More than 2,400 of your peers have already become certified via the GISCI program. Visit the GISCI booth in the exhibit hall (# 317) for more information and plan to attend the GISCI's informational session on Wednesday (4:00–5:00 PM).

First-Time Attendee Orientation Meeting

Tuesday, October 7

5:15–5:45 PM

Room: Oak Alley–4th floor

Susan Johnson (URISA President), Hilary Perkins (President-Elect), Winchester Jordan and Mike Lovett will share their tips on navigating the program; don't-miss events and sessions; networking hints, and why URISA has been important to them in their careers. Meet fellow newcomers to the URISA conference and then head out to enjoy New Orleans!

Networking Reception —

Exhibit Hall–Grand Ballroom CDE–5th floor

Wednesday, October 8

5:00–7:00 PM

Join your colleagues in the exhibit hall for the Networking Reception. Enjoy some light refreshments, meet with exhibitors, catch up with old friends and set your course for the conference. The Annual Conference & Exposition is all about making connections and the Networking Reception is the ideal place to start doing just that!

USER GROUP MEETINGS

Tuesday, October 7

Some of the exhibiting companies are having User Group meetings during the Annual Conference & Exposition

ESRI's User Group Meeting will take place in the Grand Ballroom B on the 5th floor, on Tuesday, from 5:30–7:30 PM.

Thursday Night Social Event

6:00–9:00 PM

Jazz it up with URISA!

Pat O's on the River

URISA conference attendees can Jazz it up at one of New Orleans' newest venues with the oldest reputation! Pat O'Brien's has opened the new "Pat O's on the River" which is situated in the Jax Brewery Millhouse along the majestic Mississippi River. Enjoy a fun-filled evening of great food, beverages and a New Orleans style Jazz Band.

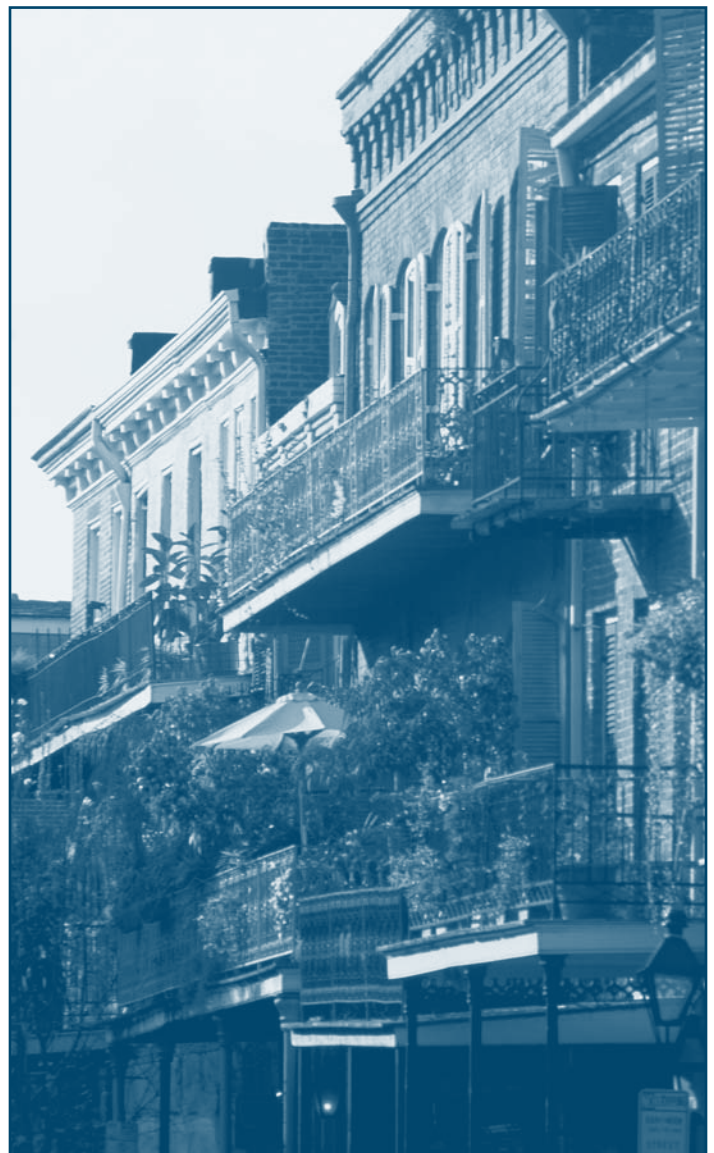

MARK YOUR CALENDAR!

URISA/NENA Addressing Conference

August 4-6, 2009

Providence, Rhode Island

**Cosponsored by the
National Emergency Number
Association**

URISA LEADERSHIP

URISA Board of Directors



PRESIDENT

Susan Johnson
Charlotte-Mecklenburg (NC)
Public Schools



PRESIDENT-ELECT

Hilary Perkins, GISP, AICP
East-West Gateway
Coordinating Council
St. Louis, MO



PAST-PRESIDENT

Ed Wells, GISP
Washington Metropolitan
Area Transit Authority
Washington, DC



SECRETARY

Cindy Braddock
Boulder County Assessor's
Office, Boulder, CO



TREASURER

Greg Babinski, GISP
King County (WA)

BOARD OF DIRECTORS



Ingrid Bruce
City of Rancho Cucamonga,
California



Jack (Al) Butler, GISP, AICP
Butler & Butler LLC
Orlando, FL



Sandi Majewski
Las Vegas Metro Police
Department



Juna Papajorgji, GISP
Alachua County
Gainesville, FL



Zhong-Ren Peng
University of Florida
Gainesville, FL



Cy Smith, GISP
State of Oregon Geospatial
Enterprise Office
Salem, OR



Geney Terry, GISP
El Dorado County
Placerville, CA

PAST PRESIDENTS

URISA evolved from conferences held from 1963 through 1966 (Annual Conference on Urban Planning Information Systems and Programs). URISA was formed in 1966 and the first URISA conference was held in 1967.

Year	President	Location of Conference
1963	N/A	Los Angeles, CA
1964	N/A	Pittsburgh, PA
1965	N/A	Atlanta, GA
1966	N/A	Berkeley, CA
1967	Edgar M. Horwood	Garden City, NY
1968	Barclay Jones	Clayton, MO
1969	Edward F.R. Hearle	Los Angeles, CA
1970	Robert Barraclough	Louisville, KY
1971	Wilbur A. Steger, Ph.D.	New Orleans, LA
1972	John Bereford	San Francisco, CA
1973	William H. Mitchel	Atlantic City, NJ
1974	Gerald G. Fox	Montreal, QC
1975	George Farnsworth	Seattle, WA
1976	Donald Luria	Atlanta, GA
1977	Robert T. Aangeenbrug	Kansas City, MO
1978	Barry S. Wellar, GISP	Washington, DC
1979	Dorothy Bomberger	San Diego, CA
1980	O. E. Dial	Toronto, ON
1981	William DeGross	New Orleans, LA
1982	Samuel B. Trotter	Minneapolis, MN
1983	Kenneth J. Dueker	Atlanta, GA
1984	Thomas M. Palmerlee	Seattle, WA
1985	William E. Huxhold, GISP	Ottawa, ON
1986	Robert V. Hurst	Denver, CO
1987	William J. Craig, GISP	Fort Lauderdale, FL
1988	Charles P. Kindlerberger	Los Angeles, CA
1989	D. David Moyer	Boston, MA
1990	Constance C. Blackmon	Edmonton, AB
1991	Gilbert H. Castle, III	San Francisco, CA
1992	Libby Clapp	Washington, DC
1993	Edward Crane	Atlanta, GA
1994	Laurel J. McKay	Milwaukee, WI
1995	Randolf A. Gschwind	San Antonio, TX
1996	R. Wayne Bannister	Salt Lake City, UT
1997	Glenn O'Grady	Toronto, ON
1998	Peter Crosswell, GISP	Charlotte, NC
1999	Joseph Ferreira, Jr.	Chicago, IL
2000	Nancy Tosta	Orlando, FL
2001	Lyna Wiggins	Long Beach, CA
2002	Peirce Eichelberger	Chicago, IL
2003	Martha Lombard, GISP	Atlanta, GA
2004	Dan Parr, GISP	Reno, NV
2005	Dianne Haley, GISP	Kansas City, MO
2006	Cindy Domenico	Vancouver, BC
2007	Ed Wells, GISP	Washington, DC
2008	Susan Johnson	New Orleans, LA

New Board Members

The following URISA members were elected to the URISA Board of Directors this year and will begin their terms on the Board at the close of this conference. Welcome aboard!

President-Elect: Kathrine Cargo, GISP, New Orleans Parish Communications District
New Board members beginning their three-year term at the close of the conference are:
Clare Brown, GISP, Montgomery Watson Harza, New Orleans, Louisiana
Michael Lovett, GISP, CDM, Maitland, Florida
Karen Stewart, GISP, ESRI Canada, Vancouver, British Columbia

At the close of URISA 2008 in New Orleans, the terms of service for these Board members will conclude:

Ed Wells, GISP (Immediate Past President), GIS Manager, Washington Metro Area Transit Authority, Washington, DC

Ingrid Bruce, GIS/Special Districts Manager, City of Rancho Cucamonga, California

Zhong-Ren Peng, PhD, Professor, University of Florida Department of Urban and Regional Planning, Gainesville, Florida

Cy Smith, GISP, Statewide GIS Coordinator, State of Oregon, Salem, Oregon

We thank them for their dedication and service to URISA and anticipate many more years of continued involvement.



Kathrine Cargo



Clare Brown



Michael Lovett



Karen Stewart

All award winners will be recognized during the first-ever URISA Awards Breakfast on Thursday morning.

Exemplary Systems in Government (ESIG) Award Winners

URISA's ESIG Awards recognize exceptional achievements in the application of information technology that have improved the delivery and quality of government services.

Enterprise Systems Category

Systems in this category are outstanding and working examples of using information systems technology in a multi-department environment as part of an integrated process. These systems exemplify effective use of technology yielding widespread improvements in the process(es) and/or service(s) involved and/or cost savings to the organization. This year, thirteen submissions were received for consideration within the Enterprise Systems category.

2008 ESIG Winner: Geospatial Incident Management System—Horry County, South Carolina

Submitted by: Timothy Oliver, GIS Manager, Horry County IT/GIS, Conway, SC

This system is exemplary for its multi-jurisdictional scope, spanning both the county and its constituent cities, and for the strong governance, infrastructure and commitment to spatially-enabled systems that were put in place. By bringing the municipalities in, and by designing the system to use regional and national applications as well, this system is ahead of its time.

The initial attention to the building of the required infrastructure (109 miles of fibre optic cable) was the foundation that made this project so successful. It features phased implementation to meet the different needs of target audiences and the development of standardized database schemas. The county also proactively approached municipalities with governance agreements to make certain that data creation, storage and maintenance functions would all take place under the same umbrella.

The system has benefited the emergency management agencies of the county and cities through streamlined, accurate and timely data to improve response and dispatching. A number of examples were given demonstrating how the system has impacted on the county by comparing how business was conducted the "old way" vs. the "new way." Besides GIS, the system is compatible with the county's E911 CAD database, real estate database and aerial photography platform.

This is an outstanding example of the full process of implementing an inter-jurisdictional system, from planning,

reaching agreements, building infrastructure, system acquisition and integration. While the short-term gains are impressive enough, it will be the longer term success that will really show the truly exemplary nature of this development. As such, the Horry County Geospatial Incident Management System is a worthy recipient of the 2008 ESIG Award for the winning entry in the Enterprise Systems Category.

Single Process Systems Category

Systems in this category are outstanding and working examples of applying information system technology to automate a specific SINGLE process or operation involving one department or sub-unit of an agency. The system application results in extended and/or improved government services that are more efficient and/or save money. This year, ten submissions were received within the Single Process Systems category.

2008 ESIG Winner: Public Works GIS Viewer—City of Fontana, CA

Submitted by Rogelio Matta, Senior Administrative Analyst, City of Fontana, CA

The City of Fontana built its public works GIS viewer in response to rapid development, new infrastructure requirements, budget constraints, the need for greater efficiency and effectiveness, and to preserve critical institutional knowledge.

By giving field staff direct access to the information they need to complete a task, efficiencies have been noted not only among the field staff but also among office staff who previously provided a great deal of support. Another benefit of the implementation included the realization that current spatial data had to be improved and corrected as part of the process, and staff now fully accept ownership and responsibility for the quality of their data.

Incremental successes resulted in increased confidence in the system, support and funding for future phases, and the flexibility to respond to technological changes along the development path. The application has improved response to citizen calls and office staff can not only address many more inquiries, but also determine which field staff are best situated to respond to calls. The system has saved costs related to vehicle maintenance and fuel, as field staff tasks and routes can now be better planned and managed. The field staff now have increased success in finding assets and overall the workforce has been empowered by direct access to data.

The system has also been used to identify sewer connections missed in the billing system, increasing city revenue.

Finally, now that the system is available, other departments are using it and adding additional spatial data layers. It has

AWARDS

become an example across the city of the effective use of GIS to solve budget constraints, improve efficiency and effectiveness of work, and to make sure knowledge and data are protected.

Accordingly, the City of Fontana Public Works GIS Viewer is a deserving winner of the 2008 ESIG Award in the single process system category.

ESIG Distinguished Systems

A number of submissions have been recognized by the ESIG Review Committee as Distinguished Systems, deserving of special recognition for the strength of their application.

Distinguished Enterprise Systems:

Illinois Virtual Tollway–Illinois Tollway

Submitted by Kurt Lebo, GIS Manager, Illinois Tollway Authority

Land Information Network (LandNet)–Singapore Land Authority

Submitted by Lim Ming Khai, Head, Land Information Centre, Singapore Land Authority

WebPuff™ - Automated Emergency Management Decision Support System–US Army Chemical Materials Agency

Submitted by Darius Kwiedorowicz, CSEPP Automation System Manager, US Army Chemical Materials Agency

Distinguished Single Process Systems:

GIPSE (Geographic Information Portal System for Everyone)–City of Aurora, CO

Submitted by William Keever, GIS Coordinator, City of Aurora, CO

North Carolina's Economic Development Intelligence System (EDIS)–NC Department of Commerce

Submitted by: Allan Sandoval, EDIS GIS Lead, NC Department of Commerce

URISA congratulates all of the participants in the 2008 Exemplary Systems in Government Award program!

2008 Student Paper Awards

URISA is pleased to announce the results of its Second Annual Student Paper Competition.

- **First Place** - Arjen Koekoek, Wageningen University - The Netherlands
"The Potential of E-Participation as Planning Support System"
- **Second Place** - Claire Brill, Clark University – Massachusetts

"Using GIS to Contrast Perceived Versus Preferred Priorities for Brownfield Redevelopment in Worcester, MA"

- **Third Place** - U. W. Tang, University of Macau, Macau (PR China)
"Data Capture and Data Mining of Urban Air Pollution: The Building-Based Approach"

Read the winning submissions online:

<http://www.urisa.org/2008student>

Horwood Distinguished Service Award

The Horwood Distinguished Service Award is named after founding member and first URISA President, Edgar Horwood. Horwood was an early pioneer in the field of information systems for local government and admired by all for his intellectual and organizational contributions to URISA. Horwood was the Chair of the constitutional drafting committee, giving URISA the "open membership" model that has led to our inter-disciplinary organization.

Horwood Distinguished Service Award History:

- 1975 Edgar Horwood
- 1979 Will Steger
- 1980 Bob Aageenbrug
- 1985 Barry Wellar, GISP
- 1988 Jack Dangermond
- 1991 David Moyer
- 1993 William Craig, GISP
- 1994 Constance Blackmon
- 1995 William DeGroff
- 1996 Ben Niemann
- 1997 Ken Dueker
- 1999 William Huxhold, GISP
- 2001 Ed Crane
- 2002 Mike Kevany
- 2004 Don Cooke
- 2005 Lyna Wiggins
- 2006 Peter Crosswell, GISP
- 2007 Nancy von Meyer, PhD, GISP

The Horwood Distinguished Service Award is an occasional award given for long-term service to URISA and the profession. This award is URISA's ultimate award for service and leadership to URISA and the geospatial industry. This year it is awarded to Peirce Eichelberger.



F. Peirce Eichelberger, GIS Manager, Chester County, PA

This year marks Peirce's 34th anniversary working with GIS and other advanced technologies in local government. He is a Past URISA President (2001-2002), has served on the URISA Board of Directors for two terms, and has presented thirteen

different URISA workshops over 25 years. He has presented many papers at URISA conferences, several of which have been instrumental in URISA's continuing growth and direction. His 1993 paper, "The Importance of Addresses--The Locus of GIS" helped launch the very successful Street Smart and Address Savvy conferences, the first of which was presented in San Antonio in 1999. This annual specialty conference, now presented in partnership with the National Emergency Number Association, is still going strong. This initiative also led to URISA's most frequently requested workshop, "Address Issues and IS/GIS Implementation" which has been presented over 100 times.

A 1994 paper, "101 Things That GIS Does Better Than CAMA" at the International Association of Assessing Officers (IAAO) Conference in Seattle, helped launch the very successful Integrating GIS & CAMA Conference, presented with IAAO and now in its 13th year.

He is currently the GIS Manager with Chester County, PA (since 1998). Significant accomplishments of Chester's GIS program are: integration with 911 addressing requirements, front-end land record integration with Recorder of Deeds, and a very popular GIS Consortium launched in 2001.

With an undergraduate degree in Geography from the University of Florida, he completed his graduate degree at the University of Cincinnati (MA in Geography 1974). After graduate school he began work with the City of Miami (FL) Planning Department and also attended his first URISA conference in Atlanta (1976). He has attended every URISA conference since!

Peirce was a Senior Systems Consultant with HDR Systems in Omaha, NE from 1980-1986 where he worked with many North American Cities and Counties. One of his design clients was Orlando/Orange County, Florida where he became the Project Coordinator for one of the largest multi-participant GIS programs in North America (1986-1993). In 1993 he joined the UNISYS Corporation as a GIS Executive Consultant. In 1995 he formed his own consulting practice, geographic Data Base Management Systems, in order to assist clients in using advanced technologies, like GIS, much more successfully. His projects have won several awards: "GIS as a Revenue Generation Tool," (NACO 1991), "GIS Supports the EOC," (NACO 2003) and URISA's prestigious ESIG Award for "Chester County Land Record's Modernization," (2002). Chester County received a Special Achievement in GIS award from ESRI in 2004. This year (2008) Chester County again achieved NACO recognition for its "Historic Resource Atlas Project." Peirce has published many articles and has been an invited speaker at many international, national and regional events. His hobbies include stamp collecting and a completely restored 1958 CJ-3B Jeep.

Leadership Award

Presented to members who have demonstrated exemplary leadership to URISA, creativity, innovation, and dedicated support of URISA programs.

Leadership Award History:

- 1979 Steve Kinzy, GISP
- 1980 Dale Richmond, Robert Harper
- 1981 Tom Palmerlee
- 1982 Ben Cramer
- 1983 D. David Moyer
- 1984 Lee P. Johnston, MacDonald Barr
- 1985 Libby Clapp
- 1986 Michael J. Kevany, Constance C. Blackmon
- 1987 William Huxhold, GISP
- 1988 Robert H. Alexander
- 1989 William J. Craig, GISP
- 1990 William J. Bamberger
- 1991 John Antenucci
- 1992 Dan Parr, GISP
- 1993 Nancy von Meyer, GISP
- 1994 Nora Evans
- 1995 Sandra Crutcher, Industry Advisory Board
- 1996 David DiSera, Mary Tsui
- 1997 Peter Van DeMark, Don Evans
- 1998 Ed Crane, Lyna Wiggins
- 1999 Peter Crosswell, GISP, Martha Lombard, GISP
- 2000 Nancy Lerner
- 2001 Hilary Perkins, GISP
- 2002 Joseph Ferreira, Jr., Nancy Tosta
- 2003 Shoreh Elhami, GISP
- 2004 Peirce Eichelberger
- 2005 Jack (Al) Butler, GISP, AICP
- 2006 URISA 2006 Conference Chairs (Cindy Braddock--Integrating GIS & CAMA Conference; Mike Walls--Geospatial Integration for Public Safety Conference; Sandi Majewski--URISA 2006 Annual Conference; Melinda Laituri--Public Participation GIS Conference; Carolann Albury--Caribbean GIS Conference)
- 2007 Dianne Haley, GISP

This year's Leadership Award recipients are Ken Dueker and Cindy Domenico.



Kenneth J. Dueker, emeritus professor of urban studies and planning, is an experienced educator and researcher in transportation, land use, and geographic information systems. He directed the Center for Urban Studies from 1979 to 1998 and the Transportation Studies Center from 1997 to 2002 at Portland State University. His areas of interest include:

AWARDS

transportation and land use interactions, travel and parking behavior, and Geographic Information Systems - Transportation.

He has chaired the Transportation Research Board Subcommittee on Geographic Information Systems - Transportation. He is a past-president of URISA and was a co-editor of the URISA Journal from 1989 to 1999. He was also the 1999-2000 president of the Oregon URISA Chapter.

In 1997 URISA awarded Dr. Dueker the Horwood Service Award, and in 2000 the Transportation Research Board appointed him as emeritus member of the Spatial Data and Information Sciences Committee. In 2001, Portland State University honored him with the Millar Award for a distinguished research record. In 2002 the Oregon Chapter of URISA awarded him its first Distinguished Service Award.

Dueker was an original member of URISA and served as its first Treasurer, 1967–1970. His major professor was Edgar Horwood, URISA's founder.

He earned his BS (1960), MS (1963), and PhD (1967) in Civil Engineering, from the University of Washington.

Ken Dueker has been published numerous times over his long and respected career.



Cindy Domenico was appointed as Boulder County Commissioner on July 2, 2007, to complete the term of Commissioner Tom Mayer, who passed away in June 2007. Prior to appointment as Commissioner, Domenico served as Boulder County Assessor for ten years. She was appointed Assessor in 1997, followed by three

consecutive 4-year term elections in 1998, 2002, and 2006. Domenico was a member of the Assessor's Office staff since 1984. Her office was responsible for the valuation of 126,000 properties, currently worth an approximate \$50 billion in market value. Domenico managed an office that has received numerous awards from public policy and appraisal organizations for excellent public service and technological innovations. Development of Boulder County's GIS and implementations of the technology for appraisal analysis have been a focus of her work as assessor.

Cindy is a Past President of URISA (2005-2006) and served as Board Treasurer during her first term on the URISA Board of Directors, 2000-2003. She has also been an active member of the International Association of Assessing Officers (IAAO), where she served as Chair of the IAAO Mapping Council and was recognized with the 2007 Distinguished Assessment Jurisdiction Award. Naturally, Cindy has been instrumental in

the growth of the Integrating GIS & CAMA Conference... she was Chair of the 1999 conference and is a frequent presenter. She has held numerous leadership positions for the Colorado Assessor's Association and was named Assessor of the Year in 2003. In 2006-2007, Cindy served on the Land Parcel Study Committee for the National Research Council of the National Academy of Sciences and was a contributing committee member for NRC's report, "National Land Parcel Data: A Vision for the Future".

Cindy Domenico is a life-long resident of Boulder County. She grew up on her family's farm near Lafayette, and received her BA in Environmental, Population, and Organismic Biology from the University of Colorado, Boulder.

Service Award

Presented to members who have demonstrated faithful service to URISA and participation in its programs over a period of several years.

Service Award History:

- 1979 Samuel Trotter, William DeGroff, John Scoggins, Myron Weiner
- 1980 Joyce Annicello, Bill Hanna, Clark Rogers
- 1981 SIGGEO (Wm. Huxhold)
- 1982 D. David Moyer, Rolf Schmitt
- 1983 Robert V. Hurst
- 1984 HDR Systems
- 1985 Irene Wreen, Rolf Schmitt
- 1986 Robert Johnson
- 1987 Rebecca Somers
- 1988 Laurel J. McKay, Mark J. Salling, GISP
- 1989 Randolph Gschwind
- 1990 Barbara Bell, Wayne Bannister
- 1991 Bijan Azad
- 1992 Matt Beckstedt
- 1993 Liam Barry, David Matson, Mary Tsui
- 1994 Robert J. Lima, William Mumbleau
- 1995 Tom Tribble, Hilary Perkins, GISP, Nancy Lerner
- 1996 Tom Clemons, Barry Wellar, GISP, Elaine Whitehead
- 1997 Tony Leno, Donald G. Baker
- 1998 Stuart Challender, Jury Konga, GISP
- 1999 Zorica Nedovic-Budic, Dianne Haley, GISP
- 2000 Mark Salling, GISP, William Bowdy
- 2001 Kim McDonough, GISP, Kathrine Cargo, GISP
- 2002 Sanjiv Gandhi, Harlan Onsrud
- 2003 URISA Certification Committee
- 2004 Anne Payne, GISP & Ed Wells, GISP
- 2005 Nigel Roberts & Steve Ventura
- 2006 Juna Papajorgji, GISP
- 2007 Michael Lovett, GISP, Lynda Wayne, GISP

C. David Hawker and Bruce Joffe, GISP are both recipients of a 2008 URISA Service Award.



Dave Hawker has been a territorial sales manager and product specialist for Tyler Technologies - Eagle Division since 1996. Prior to that, he worked for Business Records Corporation as a Tax, Assessment and Appraisal Specialist. Before his work in the private sector, Dave was a Real Estate Appraiser for the Gunnison County Assessor's

Office, was the Chief Appraiser/Deputy Assessor for Fremont County, and a Real Estate Appraiser for Elbert County Assessor's Office. Dave received his bachelor's degree from Rockmont College in Denver and has taken numerous courses on Appraisal, Assessment, and GIS. He holds several state certifications.

Dave has been a URISA member since 2003, and a URISA participant since 1998, when he attended his first Integrating GIS & CAMA Conference in Albuquerque. The very next year, Dave joined the GIS & CAMA Conference Planning Committee and hasn't stopped. He is a regular presenter and moderator at GIS/CAMA, in addition to being the most enthusiastic and devoted committee member for the past ten years. He was chair of the 2005 Conference in Savannah.

Dave has also been active as a member of URISA's Membership Committee and the Industry Relations Committee over the years and frequently presents and moderates at the URISA Annual Conference.



Bruce Joffe, GISP, AICP

Bruce Joffe is the founding Principal of GIS Consultants, providing GIS implementation planning and management services to local and state governments, utilities, and private companies. Specializing in organizational, staffing, planning, management, budgeting, and financing issues, he has helped many

successful projects get started, and some ongoing projects become more productive. In recent years, the practice has evolved beyond GIS implementation management to include organizational therapy and GIS Public Policy advocacy. Bruce is the organizer of the Open Data Consortium project, dedicated to equitable data distribution policy development, and solving the need for accessible distribution of public geodata while supporting digital data maintenance. During the first two decades of Bruce's 30-year career, he worked as lead consultant on GIS projects for several top consulting firms, including PlanGraphics, Montgomery-Watson, BSI Consultants, and Bechtel. Bruce taught GIS at a graduate seminar/lab at San Jose State University and is an instructor of the URISA Leadership Academy.

Bruce earned his degree in Architecture from the University of California, Berkeley, in 1968 and a Master's degree in City Planning, and a Master of Architecture (Advanced Studies) degree from Massachusetts Institute of Technology, in 1978.

Bruce attended his first URISA conference in 1979 and was quite active over the years at the chapter level. He was Past-President of the Tri-West Chapter many years ago and held numerous leadership positions within the BAAMA Chapter of URISA (Past President, Treasurer and Board Member). Bruce was chair of the 1996 and 2000 California GIS Conferences. Bruce was a member of URISA's Chapter Relations Committee and also served on the URISA Board of Directors (2001-2003) as Secretary. He is a current member of URISA's Policy Advisory Committee and is one of URISA's representatives on the Board of the GIS Certification Institute (Immediate Past Chair). He was also URISA's representative to the ASPRS Task Force on GIS-Survey Issues.

Bruce has been an active participant and leader within the GIS community in California and has also served on a number of federal working groups and committees.

Barbara Hirsch Special Service Award

Presented to members or staff who have made special contributions to URISA. This award was created (in 2004) to honor URISA's former Chief Financial Officer, Barbara Hirsch. This award is given to individuals or committees who have shown a consummate level of service to URISA through an ongoing commitment to our success as an organization.

Special Service Award History:

- 2004 URISA Staff
- 2005 Street Address Standard Working Group: Martha Lombard, GISP; Hilary Perkins, GISP; Ed Wells, GISP; Sara Yurman; and Carl Anderson
- 2006 Eric Bohard, GISP and the Website Task Force (Dan Zezas, Tom Kimpel, GISP, Tim Case, GISP, Gurdeep Singh, Marc Forgang and Michael Tasker, GISP)
- 2007 Allen Ibaugh, GISP

The 2008 Barbara Hirsch Special Service Award is awarded to Jochen Albrecht, Editor of the URISA Journal and also to the Committee and Instructors of the URISA Leadership Academy.



Jochen Albrecht received his PhD in GIScience in 1995 based on his research that involved the development of a user interface allowing the creation of vendor-independent GIS process models. His work receives renewed attention, now that we move from a desktop to a web services oriented

AWARDS

environment. For the following four years, he worked as Lecturer and Senior Lecturer at the University of Auckland, New Zealand. During this time he became the Chair of the New Zealand chapter of our sister organization AURISA. His work during those years concentrated on standardization with ANZLIC and ISO, and within (A)URISA on certification of GIS professionals.

In the year 2000 Jochen returned to the United States to work as assistant professor, first at UW Milwaukee and then from 2002 on at UMD College Park. On the applied side, Jochen collaborated with explored aspects of GIS as a communication tool, e.g., between city agencies and non-profit organizations and learned to appreciate the professional work of organizations such as the National Capital Planning Commission. On the academic side, Jochen advanced the dynamic aspects of GIS by linking GIS with agent-based modeling systems.

Since late 2004 Jochen is associate professor at Hunter College in New York City, where his research involves working with municipal datasets that rival in size and complexity those of not so small countries. Recent projects include hazard management, transportation, renewable energy, and a wide range of public health issues. In 2006 Jochen became the editor of the URISA Journal, where he tries to combine the traditional emphasis on academic excellence with the notion of relevance to the spatially-aware IT professional.

URISA Leadership Academy

At URISA's Annual Conference in Washington DC in late August 2007, a group of members led by Hilary Perkins, came up with the idea of the URISA Leadership Academy. An amazingly short time later, the first ULA debuted in December 2007 to rave reviews. The second program was held in Chicago this past June. The ULA has become a sought-after educational program for GIS professionals and is another example of a successful volunteer effort come to reality.

A number of individuals have helped to make the ULA a success: Keota Silaphone (Chair), Hilary Perkins, Mike Lovett, Dianne Haley, Shoreh Elhami, Rebecca Somers, David Lanter, Susan Pulsipher, Pete Crosswell, Keith Fournier, Claudia Paskauskas, Danielle Ayan, Louise Fragala, Clare Brown, Carl Anderson, Al Hill, Bruce Joffe, Greg Babinski, Geney Terry, Kim McDonough, Martha Wells, Sara Yurman, and Valrie Grant-Harry.

Outstanding Chapter Award

Each year, URISA recognizes an outstanding Chapter that has sponsored particularly effective activities or has otherwise excelled in serving its membership. Outstanding Chapter Award criteria include:

- Innovation
- Outreach

- Education
- Community Impact

Outstanding Chapter Award History:

- 1995 Rocky Mountain
- 1996 Ontario
- 1997 Midwest Gateway
- 1998 BAAMA
- 1999 Southern California
- 2000 Alberta
- 2001 Oregon
- 2002 Georgia
- Ontario
- Florida & Southern California
- British Columbia
- 2006 Washington
- 2007 Georgia

The winner of the 2008 Outstanding Chapter Award is the **URISA Carolina Chapter**. Congratulations on your accomplishments!

GISCorps Recognition

Special GISCorps Recognition

- David Allen: Post Katrina Mission in Biloxi, MS; Partner Agency: Golf Coast Community Design Studio, August 2007
- Heather Milton: Post Missouri Flood, Missouri; Partner Agency: St Louis County EOC, March 2008
- Tom Ponte: Post Cyclone Nargis, Myanmar (Burma); Partner Agency: United Nations Operational Satellite Applications Programme (UNOSAT), May/June 2008

For a complete list of GISCorps projects and volunteers, visit: www.giscorps.org



MARK YOUR CALENDAR!
13th Annual Integrating GIS & CAMA
Conference
February 8-11, 2009
Charleston, SC
Cosponsored by the International
Association of Assessing Officers

CONFERENCE PROGRAM—TUESDAY

8:30 AM–5:00 PM	Full-Day Workshops
12:00 NOON–1:30 PM	Lunch on own
5:15–5:45 PM	First-Time Attendee Orientation Meeting

2008 Annual Conference & Exposition Pre-Conference Workshops Tuesday, October 7, 2008 8:30 AM–5:00 PM

For more than 40 years, URISA has been the center for information exchange among professionals dealing with urban and regional issues. The Annual Conference workshops have been and are still considered some of the best real-world and practical learning experiences for attendees. Attendance at one pre-conference workshop is included in your full conference registration (normally a \$195 fee).

Quality Management: Introduction to Issue Tracking

Room: Edgewood AB–4th floor

*Instructors: David Lanter, GISP, CDM, Philadelphia, PA
Cory Rogers, CDM, Carbondale, IL*

Issues affecting the quality of geospatial datasets, applications, maps and reports include errors, new feature requests, and usability problems. These issues can negatively impact utility of geospatial products and decision making they support. Unresolved issues reduce user satisfaction, and the users' trust in the organizations that produce them. Ineffective quality management can also block project completion. As such, geospatial quality problems issues are important to find, prioritize, and effectively resolve. This workshop provides practical ways to manage geospatial product quality issues, illustrates how to communicate about geospatial product quality issues, and introduces how to manage quality improvement while attending to budgets and schedules.

Addresses and IS/GIS Implementation: Key to GIS Success

Room: Grand Couteau–5th floor

*Instructors: Martha Wells, GISP, Spatial Focus Inc., Birmingham, AL
Randal Krejcarek, PE, City Engineer, City of Delray Beach, FL*

Street addresses are the key, user-friendly geospatial identifier used by everyone, but addressing processes are usually poorly organized at the local level. This workshop will help you understand the addressing process, managing address data, and organizational challenges. It will guide you in developing a Master Address Repository that serves the needs of the entire organization. The workshop will also review the new draft Federal Geographic Data Committee Street Address Data Standard (in review), and help you understand how the standard can help you build quality address data.

An Overview of Open Source GIS Software

Room: Grand Chenier–5th floor

*Instructors: Sara Yurman, Spatial Focus, Inc., Decatur, GA
Carl Anderson, Fulton County, Atlanta, GA*

Free and open source software (FOSS) has been offering choices to computer users for a number of years. Over the past few years the open source choices in GIS have been broader and more capable than ever before. This workshop will focus on GIS open source software. It will give an overview of current developments from technical and management perspectives. Selected packages and their applications in various projects will be demonstrated and discussed.

Asset Management: Planning, Strategy, and Implementation

Room: Gallier AB–4th floor

*Instructors: Jason Amadori, GISP, Data Transfer Solutions LLC, Orlando, FL
Allen Ibaugh, GISP, Data Transfer Solutions LLC, Orlando, FL*

Public and private agencies face continuous challenges to accomplish more with less as increases in demand, regulatory requirements, infrastructure deterioration, and political and economic forces have significantly outpaced increases in capital and operating budgets. Many of these agencies are turning to Asset Management to cope with these challenges and improve business performance and effectiveness. This workshop will focus on several aspects of developing an asset management system that could help improve performance, reduce long-term costs, and maximize return on investment in infrastructure assets.

Best Practices for Developing Geographic Information Models

Room: Nottaway–4th floor

*Instructors: David Arctur, OGC Interoperability Institute, Austin, TX
Doug M. Adams, Baltimore County, Towson, MD*

Even with decades of experience, effective design of a GIS database remains a combination of art and science. This workshop shows how you can build on your existing data and skills to take advantage of the latest generation of GIS tools and practices for database design. After an introduction to the fundamental concepts of GIS database design, we will present and discuss case studies of GIS databases designed for managing land parcels, inventorying municipal facilities for emergency preparedness, and automating a permit application. In the exercises, you will develop portions of conceptual, logical and physical data models. Through these case studies of successful and effective systems, you will gain a better understanding of the issues you can face, as well as the tools and processes you can apply, in developing many other kinds of systems.

Building Quality Spatial Data—New!

Room: Oak Alley–4th floor

*Instructors: Andrew Baranowski, GISP, CDM., Fort Lauderdale, FL
James Carolan, CDM, Cambridge, MA*

Spatial data plays a big part in the Information Age, from on-line mapping services to downloadable data from thousands of

CONFERENCE PROGRAM—TUESDAY

government agencies. Do you always trust spatial data? Do your users trust your GIS data? Creating and maintaining accurate spatial data is one of the keys to a successful GIS implementation. Without quality data, the most user-friendly GIS will not be accepted and used by its intended audience. This course will present best practices, processes, quality control and quality assurance techniques for developing and maintaining high quality spatial data that users will trust and utilize.

GIS Enterprise Architecture & System Integration

Room: Southdown—4th floor

*Instructors: Karen Stewart, GISP, ESRI Canada Limited, Vancouver, BC Canada
Tom Pattison, ESRI, Redlands, CA*

The objective of this workshop is to examine both GIS enterprise architecture and the integration between various systems (GIS included) in an organization. Workshop instructors will examine the past, current, and future of GIS within an enterprise context, and apply the experience, discipline, and future direction of the Information Systems (IS) profession to Geographic Information Systems (GIS). This workshop will provide GIS professionals with an understanding of some of the complex technical and specific technical management issues that must be addressed when developing a corporate

GIS Program Management

Room: Salon 816—8th floor

*Instructors: Peter Crowell, GISP, Crowell-Schulte Inc., Frankfort, KY
Greg Babinski, GISP, King County, Seattle, WA*

Today, most government organizations have some type of GIS programs in place. They vary from being in their early stages, to rebuilding or tuning up phase, to completely being changed as new technologies and applications emerge. This workshop is designed to provide guidelines for managing your GIS program. It will look at the various organizational and technical issues program managers must address in order to develop a successful GIS program. The discussions will include managing all aspects of a GIS

program from staffing and budgeting to procuring technology and working with vendors. A variety of real world examples will be presented showing a range of GIS programs and their implementations. This workshop presents an overview of successful and unsuccessful techniques for implementing GIS.

GIS Strategic Planning—New!

Room: Grand B—5th floor

Instructors: Rebecca Somers, Somers St Claire GIS Management Consultants, Fairfax, VA

Strategic planning is a vital tool for all geospatial programs, at any stage of development. An effective strategic plan is crucial to ensuring that a GIS program gets started right. As a GIS program matures, strategic planning methods are important tools for program management, program review, responding to change, and solving problems. An effective strategic plan will help you win program approval and funding, ensure that program goals and return on investment are achieved, and keep a program on track in a changing environment. This course teaches strategic planning methods and tools in the context of developing and managing a GIS program. Participants will learn how to successfully select and apply appropriate methods for a variety of situations.

An Introduction to Public Participation GIS: Using GIS to Support Community Decision Making

Room: Salon 825—8th floor

*Instructors: Judy Colby-George, GISP, Spatial Alternatives Inc., Yarmouth, ME
Laxmi Ramasubramanian, Hunter College of The City University of New York, New York, NY*

As GIS becomes more widely available, many organizations and community groups are taking GIS out of the back room and are using it in public settings. Using GIS technology to engage various “publics” in decision making requires more than traditional GIS skills. This course focuses on the process of entering into this type of engagement. It will also review how GIS techniques and software can be adapted for use

in community settings. Using real world examples, the course will explore both government and community-led projects that encourage citizen participation and engagement. Although this workshop will be focused on PPGIS within North America our case studies will illustrate the wide variability in the presence of governmental, societal, and technological infrastructure in different communities.

LIDAR Concepts, Principals and Applications

Room: Salon 828—8th floor

*Instructors: Brian Raber, GISP, Merrick & Company, Aurora, CO
Doug Jacoby, GISP, Merrick & Company, Aurora, CO*

LIDAR (LIght Detection And Ranging) has become widely accepted tool to generate accurate terrain models used in a variety of GIS applications. This workshop will provide an overview of this exciting technology. A history of this advanced mapping tool will be discussed as well as a review its current and future trends. The workshop will describe potential applications and will provide case studies of how this data has been used by agencies throughout the United States.

Public Data, Public Access, Privacy, and Security: U.S. Law and Policy

Room: Salon 817—8th floor

*Instructors: Ed Wells, GISP, Washington Metro Area Transit Authority, Washington, DC
Mary Tsui, Land Systems Group, Monterey, CA*

As data distribution capacities increase, there is increasing tension between access to public records as a foundation of a free society, citizen expectations of confidentiality, and protection of public security. What data are subject to Freedom of Information laws? What about privacy restrictions and homeland security concerns? Can a government raise revenue (or defray maintenance costs) by charging market prices for the data? What about liability for data errors? This workshop will focus on the critical legal issues and the policy options they frame.

CONFERENCE PROGRAM—TUESDAY

First-Time Attendee Orientation Meeting Tuesday, October 7, 2008

5:15–5:45 PM

Room: Oak Alley—4th floor

Susan Johnson (URISA President), Hilary Perkins (President-Elect), Winchester Jordan, and Mike Lovett will share their tips on navigating the program; don't-miss events and sessions; networking hints, and why URISA has been important to them in their careers.

5:30– 7:30 PM

Vendor–Sponsored Sessions

Exhibitors will have this opportunity to connect with current and potential clients within a classroom setting. Find out about exciting technology being introduced and connect with fellow users.

ESRI's User Group Meeting will take place in the Grand Ballroom B on the 5th floor



URISA Corporate and Business Members

The organizations that have joined URISA as Corporate and Business Members are extremely valuable to the association, not only because of the great financial contributions they make, but also because many of their employees participate on committees and help URISA to keep up with trends in the industry. Without their support, URISA would not be able to accomplish as much as it does each year.

Federal Agency Member

U.S. Census Bureau

Corporate Members

ESRI—*Platinum Corporate Member*
Autodesk—*Gold Corporate Member*
Michael Baker Corporation—*Gold Corporate Member*

Bowne Management Systems Inc
CDM - Camp Dresser & McKee Inc.
Geographic Technologies Group
Hart InterCivic
KCI Technologies, Inc
Manatron Inc
Merrick & Company
Mobile Video Services Inc
Optimal Geomatics Inc
Pictometry International Corp
Pinnacle Mapping Technologies Inc
Pixxures, Inc.
Sierra Systems Consultants Inc
Surdex Corporation
TerraGo Technologies
The Schneider Corporation
The Sidwell Company

Business Members

Data Transfer Solutions—*Silver Business Member*
eGPS Solutions Inc—*Silver Business Member*
Colorado CustomWare Inc
GIS Innovations Ltd
Geotek Mapping
GIS Planning Inc
Kessler GIS
MGP Inc
Munsys Inc
New Urban Research Inc.
North River Geographic Systems Inc.
Orion Technology Inc
Spatial Focus Inc
spatialest
Systems Design Inc
Tetra Tech
Tyler Technologies - Eagle Division
VIXXI Solutions Inc
Wellar Consulting

URISA Headquarters

1460 Renaissance Drive, Suite 305
Park Ridge, IL 60068 USA
Phone: 847/824-6300
Fax: 847/824-6363
info@urisa.org
www.urisa.org

URISA Staff

Accounting Manager

Ann Bishopp
abishopp@urisa.org

Meetings Coordinator

Pat Francis
pfrancis@urisa.org

Conference Manager

Christopher Grace, CMP
cgrace@urisa.org

Data Processing Manager & Registrar

Verlanda McBride
vmcbride@urisa.org

Office Manager

Katie Morehead
katie@urisa.org

Executive Director

Wendy Nelson
wnelson@urisa.org

CONFERENCE PROGRAM—WEDNESDAY

7:00 AM–5:00 PM	Conference Registration Desk Hours
9:00–10:00 AM	Welcome, Keynote Address
10:00–10:30 AM	Coffee Break in Exhibit Hall
10:00 AM–7:00 PM	Exhibit Hall Hours
10:30 AM–12:00 NOON	Educational Sessions
12:00 NOON–2:00 PM	Roundtable Luncheon and Exhibit Hours
2:00–3:30 PM	Educational Sessions
4:00–5:00 PM	Educational Sessions
5:00–7:00 PM	Exhibit Hall Networking Reception

GENERAL SESSION | **Welcome & Keynote Address** | **9:00–10:00 AM** | **Room: Grand Ballroom A/B–5th floor**

Susan Johnson, URISA President, will welcome attendees to URISA's 46th Annual Conference & Exposition. Mike Lovett and Danielle Ayan will point out some of the conference highlights and then introduce our esteemed keynote speaker, David Gisclair.

Keynote Address: GIS and its Impact on the Louisiana Area

Join David Gisclair as he explores the geospatial aspects of the coastal Louisiana Region, and how remote sensing and GIS technology have provided a better understanding of the current situation in the Gulf Coast area. Learn how advances in Enterprise GIS technologies have helped in the recovery and rebuilding of post-Katrina Louisiana, as well as the lessons learned recently during Hurricane Gustav.

David Gisclair presently serves as the Technical Assistant Program (TAP) Director for the Louisiana Oil Spill Coordinator's Office in the Office of the Governor. In the course of his professional career, David has earned a Petroleum Engineering degree, Computer Science degree, and MBA. In 1993, David moved to Baton Rouge and began employment with the State of Louisiana. This position led to his current assignment in the Office of the Governor. In this executive position, he has persevered in acquiring GIS information, which not only addresses the Technical Assistance Program mission, but simultaneously addresses the needs of many local, state, and federal government entities as well as the private sector. Much of the information presented today is a result of the coordinated effort by the executive branch of Louisiana government.

We will then welcome Dr. Christopher Pettit, Chair of the Spatial Information & Cartography Commission for the Spatial Sciences Institute in Australia and SSI's representative to the URISA Conference this year. Chris will give us an update on the activities of SSI.

REFRESHMENT BREAK IN THE EXHIBIT HALL | **10:00–10:30 AM**

EDUCATIONAL SESSIONS | **10:30 AM–12:00 NOON**

CROSS JURISDICTIONAL COLLABORATION | **A Focus on Addressing and Centerlines** | **Room: Grand Ballroom A–5th floor**

Planning and responding to events, those fundamental to business or catastrophic in nature, requires reliable information and cooperation from a variety of sources. This session highlights proven cases of effective cross-jurisdictional collaboration.

Moderator: Randy Fusaro, US Census Bureau, Washington, DC

2008 ESIG WINNER Horry County, S.C.—The Grand Strand
 Census 2010—Local Update of Census Addresses (LUCA) Program in Delaware County

The Vision for a Nation-wide Address Database

Tim Oliver, Horry County IT/GIS, Conway, SC
 Shoreh Elhami GISP, Delaware County Auditor's Office, Delaware, OH
 Jon Sperling, US Department of Housing and Urban Development, Washington, DC
 Will Craig, GISP, University of Minnesota, Minneapolis, MN

CONFERENCE PROGRAM—WEDNESDAY

MANAGEMENT & PROFESSIONAL
DEVELOPMENT

Key Issues in County & Regional GIS Program Development

Room: Grand Ballroom B-5th floor

Development and Implementation of a successful County or Regional GIS Program can be challenging on many fronts. This session addresses some of the key relevant issues such as hiring a GIS Manager, creating a Strategic Plan, Data Licensing/Dissemination and Application Usage Monitoring.

Moderator: Gene Del Greco, GISP, Richland County Planning Commission, Mansfield, OH

A Strategic Plan for Countywide GIS

Tracking the Elusive Anonymous GIS User in King County

GIS Data Sharing: A Canadian Regional Government Perspective

Peter Owen, GISP, County of San Mateo-ISD, Redwood City, CA

Greg Babinski, GISP, King County GIS Center, Seattle, WA

David Murray, TransLink, Burnaby, BC, Canada

3D GIS

Urban 3D

Room: Grand Chenier-5th floor

Adding the 3rd dimension to planning information systems is a significant paradigm shift in both technical design capabilities as well as public understanding. Virtual models are depicting existing built form as well as proposed new development in ways never before possible. This session discusses experiences from both a vendor and user perspective.

Moderator: Tom Conry, Fairfax County, Fairfax, VA

Using 3D GIS as a Tool to Integrate Factors Associated with Planning

Virtual 3D City Models as Foundation for 3D Planning Information Systems

360° Street-level Video: The Next Step

Jorge Morteo, GISP, City of Las Vegas, Las Vegas, NV

Lutz Ross, Berlin Institute for Technology, Berlin, Germany

Ken Hoffman, Immersive Media Co, Cypress, TX

GEOSPATIALLY ENABLED
ENTERPRISE

Enterprise GIS Implementation

Room: Bayside Ballroom A-4th floor

Learn how to integrate GIS into an organization. Look at 13 specific issues (related to people, strategy/business, and project management) to be aware of during technology implementation and how to get beyond them.

Moderator: Milo Robinson, FGDC, Reston, VA

Thirteen Key Issues to Address in Technology Implementation

Marianne Mac Donald, CDM - Camp Dresser & McKee Inc, Cambridge, MA

EMERGENCY MANAGEMENT &
HOMELAND SECURITY

The State of the Virtual State

Room: Nottaway-4th floor

During times of emergency, the last thing emergency responders and decision makers need to worry about is a lack of spatial data to support their response efforts. Recently, many states have been making a concerted effort to collect local spatial data in a central location for the benefit of emergency responders and citizens alike. Two states, Alabama and Louisiana, have created web sites, *Virtual Alabama* and *Virtual Louisiana*, in response to this need. Attend this panel discussion and hear from the creators of the virtual states, their challenges, and the benefits of their work. Questions from audience members will be accepted during the presentation.

Moderator: Danielle Ayan, GISP, Georgia Institute of Technology, Atlanta, GA

Chris Johnson, GISP, U.S. Space & Rocket Center, Huntsville, AL

Brant Mitchell, Governor's Office of Homeland Security and Emergency Preparedness, Baton Rouge, LA

PPGIS

New Technologies: Enhancing PPGIS

Room: Gallier-4th floor

New technology is improving the effectiveness of PPGIS. This session demonstrates case studies using these new technologies.

Moderator: Clare Brown, GISP, Montgomery Watson Harza, New Orleans

Empowering Communities using Google Maps API

More than Just Maps: Engaging the Public with Real-Time GIS Models

Interactive Decision Support for Participatory Land Use Planning

Wansoo Im, Vertices LLC, New Brunswick, NJ

Erin Perdu, GISP, ENP & Associates, Ann Arbor, MI

Gustavo Arciniegas, Vrije Universiteit, Amsterdam, The Netherlands

CONFERENCE PROGRAM—WEDNESDAY

DATA ACQUISITIONS & CONVERSION

Ground Control to Major Tom

Room: Bayside Ballroom C-4th floor

Effecting change through feedback can show limitations to your data usability and guide maintenance solutions through broad user community input.

Moderator: Ed Crane, ESRI, Leawood, KS

High Field Productivity with Low Cost Tools - Two Examples

Improving Vertical Geodetic Data: Not So Easy in the "Big Easy"

Using Innovative Tools to Ensure GIS Data Quality

Mark Lyon, GISP, Shaw Environmental Inc, Albuquerque, NM

Gilbert Mitchell, NOAA, Silver Spring, MD

David Moyer, National Geodetic Survey, Madison, WI

Tamarin Gullett, Cherokee County GIS Department, Canton, GA

Jim Bohn, GISP, DataLOGIC, Inc. Atlanta, GA

OPEN SOURCE AND OPEN STANDARDS

Building Applications with Open Source Technologies

Room: Oak Alley - 4th floor

This session visits building applications with Open Source: KISS - Keep it Simple Stupid.

Moderator: Gary Hunter, University of Melbourne, Parkville, Australia

Building Open Source Applications—Don't Bite Off More Than You Can Chew

Ordinary Open Source Apps for Every Day

Web Mapping Using Open Source Technologies

Eric Bohard GISP, Clackamas County, Oregon, Oregon City, OR

Sara Yurman, Spatial Focus, Decatur, GA

Mark Obremski, IMAGINiT Technologies, South Jordan, UT

INTERACTIVE TRACK

Strategic Communication Planning - Moving the Mountain

Room: Grand Couteau-5th floor

Part 1 of 2 (Session will continue from 2:00–3:30 PM)

Imagine a time when all the members and partners of your organization are, for one year, unified around these core messages: how to reach particular stakeholder groups from their value perspective; how messages are voiced; who transmits the complementary pieces of each message; when and how the sequence of messages are communicated throughout the year; and how success in communicating these messages is measured.

This session on Strategic Communication Planning is an interactive session designed to result in an actionable Strategic Communication Plan for URISA that will be implemented over the next year - and to set precedence for years to come. In creating this strategic communication plan for URISA, you will develop a template and techniques to use with your own organization.

A simple but eloquent Strategic Communication Plan is necessary to:

- 1) Effectively turn strategic vision to action
- 2) Coalesce our normally disparate communities to unified purpose
- 3) If replicated annually, establish a culture of incremental progress toward a unified vision - the distant "future state"

This session continues at 2:00 PM in the same room

Facilitators

Cy Smith, GISP, Statewide GIS Coordinator, State of Oregon, Salem, OR

Scott Riordan - Oregon State CIO's Office, Salem OR

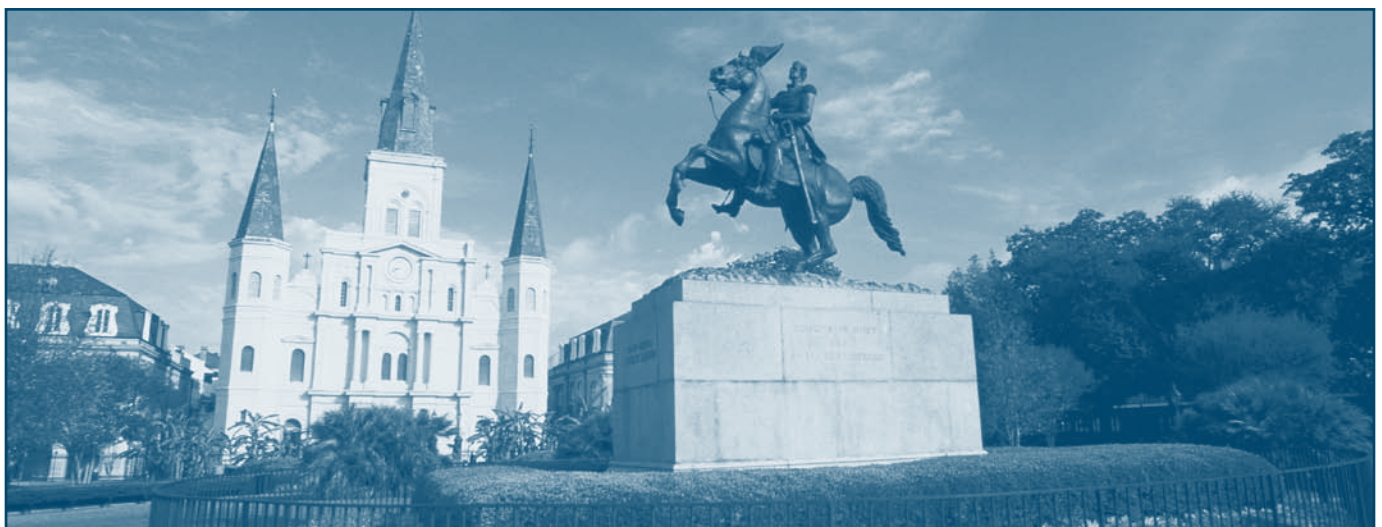

CONFERENCE PROGRAM—WEDNESDAY

12:00 NOON–1:00 PM

Roundtable Discussion Luncheon

Room: Grand Ballroom DE–5th floor

Networking at its finest! Discuss your interests over lunch with your peers. Choose the topic of most interest to you — from management issues to database design, privacy, and data sharing — and join in the conversation. You'll be amazed at the wealth of ideas that your colleagues have!

All full conference registrants received a ticket for the Roundtable Topic Luncheon. This is an excellent opportunity for networking and picking up some helpful hints from your colleagues! Choose the discussion table topic that most interests you and join in the conversation. Don't forget your luncheon ticket! The topics and corresponding table numbers follow:

- | | | | |
|---|--|---|---|
| 1. 3-D where is it going? | 12. GIS for Landscape Ecological Planning | 22. Adding Open Source to your Enterprise | 32. URISA Leadership Academy |
| 2. Addressing Cadastral Issues | 13. GISP | 23. Planning / Urban Issues | 33. URISA Website – let's talk about a redesign...volunteers? |
| 3. Crime / Crime Mapping / Investigative Applications | 14. GISCorps | 24. PPGIS | 34. URISA – "Got Some Time – Our Committees Could use You" |
| 4. Data Distribution Policy (pricing) | 15. GPS & AVL Technology | 25. Privacy & Public Policy | 35. Web-based Data Interoperability |
| 5. Data Sharing / Data Standards | 16. Homeland Security | 26. Public Health | 36. Let's talk - 2009 Annual Conference |
| 6. Enterprise GeoSpatial Integration | 17. Critical Infrastructure Planning | 27. Regional Consortiums | 37. Non-Technical Talk: Sports |
| 7. Environmental / Natural Resources | 18. Natural Disaster Emergency Preparedness & Response | 28. Rural & Agricultural / Small Systems | 38. Non-Technical Talk: The URISA Knitting & Crocheting Guild |
| 8. Ethics for GIS Professionals | 19. K-12 GIS Education | 29. Social Networking – Facebook, LinkedIn, Twitter – how can URISA capitalize on this? | 39. Non-Technical Talk: Travel |
| 9. Working with NSGIC – Imagery for the Nation, Ramona, 50 State Initiative | 20. MAGY (Microsoft, Ask, Google, Yahoo) | 30. Transportation and Transit | 40. Leave me alone - I just want to eat lunch! |
| 10. GIS / Surveying Issues | 21. Mobile GIS | 31. URISA Chapters | |

1:00–2:00 PM

Head to the Exhibit Hall for dessert and more conversation.

EDUCATIONAL SESSIONS

2:30–3:30 PM

Spatial Data Collaboration in Louisiana

Room: Grand Ballroom A–5th floor

A panel on Louisiana GIS Data Prioritization, Procurement, Management and Dissemination: A panel discussion with focus on ortho-imagery and elevation data using LiDAR.

Moderator: Kathrine Cargo, GISP, Orleans Parish Communications District, New Orleans, LA

Panelists:

David Gisclair, Louisiana Oil Spill Coordinators Office, Baton Rouge, LA

Lynn Dupont, New Orleans Regional Planning Commission

Craig Johnson, Louisiana State University

CROSS-JURISDICTIONAL COLLABORATION

Real World GIS Skills Development from Classroom to Boardroom

Room: Grand Ballroom B–5th floor

Some of us seek out GIS as a profession while some of us have the profession of GIS thrust upon us (and find out we like it!). The book learning of GIS often does not translate into "real world" experience. These experts will discuss the evolution of GIS skills from entry level GIS staffers to seasoned professionals.

Moderator: Peirce Eichelberger, Chester County, West Chester, PA

Bringing Operational GIS into University Classrooms

Soft Skills a GIS Professional Needs to Succeed

What is the ULA?

Wendy Guan, Harvard University, Cambridge, MA

Chris Thomas, ESRI, Redland, CA

Hilary Perkins, GISP AICP, East-West Gateway Coordinating Council, St Louis, MO

Mike Lovett, GISP, CDM Camp Dresser & McKee Inc, Maitland, FL

MANAGEMENT & PROFESSIONAL DEVELOPMENT

3D on the Fly

Room: Grand Chenier–5th floor

Advances in 3D visualization tools and methodologies have assisted practitioners in developing creative solutions that address day-to-day operational challenges. Fly-through and LiDAR technologies will be discussed and presented.

Moderator: Zhong-Ren Peng, University of Florida, Gainesville, FL

Data Management of Large 3D Urban Scenes

Dynamic Visualization: A Power Line Case Study

Automated Feature Extraction Using 3-D GIS - A Case Study of Mobile Mapping

Xavier Lopez, Oracle Corporation, Nashua, NH

Helen Peng, Fugro EarthData Inc, Orlando, FL

Jason Amadori, GISP, Data Transfer Solutions, LLC, Orlando, FL

3D GIS

PROGRAM-AT-A-GLANCE

Monday, October 6, 2008

Board of Directors Meeting—Nottaway (4th Fl)
Chapter Leaders Forum—Oak Alley (4th Fl)

TUESDAY, OCTOBER 7, 2008						
Preconference Workshops	Quality Management: Introduction to Issue Tracking <i>R: Edgewood—4th Fl</i>	An Overview of Open Source GIS Software <i>R: Grand Chenier—5th fl</i>	Asset Management: Planning, Strategy, and Implementation <i>R: Gallier—4th Fl</i>	Best Practices for Developing Geographic Information Models <i>R: Nottaway—4th Fl</i>	GIS Enterprise Architecture & System Integration <i>R: Southdown—4th Fl</i>	GIS Program Management <i>R: Salon 816—8th Fl</i>

5:15-5:45 PM First-Time Attendee Orientation Meeting (Oak Alley- 4th Fl)

WEDNESDAY, OCTOBER 8, 2008						
9:00–10:00 AM	Welcome & Keynote Address - Room Grand A/B					
10 AM–7 PM	Exhibit Hall Hours					

10:30 AM–12:00 NOON	Cross-Jurisdictional Collaboration A Focus on Addressing and Centerlines <i>R: Grand A—5th Fl</i>	Management & Professional Development Key Issues in County & Regional GIS Program Development <i>R: Grand B—5th Fl</i>	3D GIS Urban 3D <i>R: Grand Chenier—5th Fl</i>	Geospatially Enabled Enterprise Enterprise GIS Implementation <i>R: Bayside A—4th Fl</i>	Emergency Security The State of Emergency <i>R: Nottaway</i>
---------------------	--	---	---	---	---

12:00–2:00 PM Roundtable Luncheon – Grand Ballroom D/E & Dessert in the Exhibit Hall

2:00–3:30 PM	Cross-Jurisdictional Collaboration Spatial Data Collaboration in Louisiana <i>R: Grand A—5th Fl</i>	Management & Professional Development Real World GIS Skills Development from Classroom to Boardroom <i>R: Grand B—5th Fl</i>	3D GIS 3D on the Fly <i>R: Grand Chenier—5th Fl</i>	Geospatially Enabled Enterprise Service-Oriented Architectures and Open Frameworks <i>R: Bayside A—4th Fl</i>	Natural Resources Land Use Change <i>R: Gallier—4th Fl</i>
--------------	--	---	--	--	---

3:30–4:00 PM Break in exhibit hall

4:00–5:00 PM	Cross-Jurisdictional Collaboration Cooperative Orthoimagery Acquisition <i>R: Grand A—5th Fl</i>	Management & Professional Development Update on URISA Initiatives <i>R: Grand Chenier—5th Fl</i>	Privacy & Public Access <i>R: Grand B—5th Fl</i>	Geospatially Enabled Enterprise GIS and Content Management Integration <i>R: Bayside A—4th Fl</i>	Natural Resources Water Quality <i>R: Gallier—4th Fl</i>
--------------	---	---	--	--	---

5:00–7:00 PM Exhibit Hall Networking Reception

THURSDAY, OCTOBER 9, 2008						
8:30–10:00 AM	Awards Breakfast – Grand Ballroom D/E					
10 AM–4 PM	Exhibit Hall Hours (10:00 – 10:30 Break in exhibit hall)					

10:30 AM–12:00 NOON	Geospatially Enabled Enterprise Efficiencies from Geospatially Enabled Enterprise Systems <i>R: Grand A—5th Fl</i>	Management & Professional Development Understanding the Responsibilities of Surveyors and GIS Professionals <i>R: Bayside A—4th Fl</i>	3D GIS 3-D(istribution) and Use <i>R: Grand Chenier—5th Fl</i>	Geospatially Enabled Enterprise Data Integration & Enterprise Case Studies <i>R: Gallier—4th Fl</i>	Emergency Security Disaster Recovery <i>R: Nottaway</i>
---------------------	---	---	---	--	--

NOON-1:30 PM Lunch on own & exhibits

1:30–3:00 PM	Emergency Management & Homeland Security Postal Data & Google Maps Shine Light on New Orleans Recovery <i>R: Grand Chenier—5th Fl</i>	Management & Professional Development Keys to Project and Program Success from Vision to Assessment <i>R: Grand B—5th Fl</i>	Data Acquisition and Conversion 3D Adds Volume <i>R: Grand A—5th Fl</i>	Geospatially Enabled Enterprise Master Address Data Management <i>R: Gallier—4th Fl</i>	GIS in Public Health Approaches to Public Health Geospatial <i>R: Bayside A—4th Fl</i>
--------------	--	---	---	--	--

3:00–4:00 PM Break in exhibit hall

4:00–5:00 PM	Cross-Jurisdictional Collaboration A Business Case for Data Sharing <i>R: Grand A—5th Fl</i>	Management & Professional Development Managing GIS Projects with Agile Practices <i>R: Bayside A—4th Fl</i>	URISA Initiatives How to Make the Most of URISA Membership <i>R: Oak Alley—4th Fl</i>	Geospatially Enabled Enterprise Capital Investment Planning <i>R: Grand B—5th Fl</i>
--------------	---	--	--	---

6:00–9:00 PM Conference Social Event – Pat O's on the River, Jax Millhouse

FRIDAY, OCTOBER 10, 2008						
8:30–10:00 AM	Public Health & Safety Case Studies in GIS and Public Health <i>R: Bayside A—4th Fl</i>	Management & Professional Development Identifying and Evaluating Geospatial Competencies <i>R: Grand Chenier—5th Fl</i>	GISCorps Volunteers Assist in Post Cyclone Disaster in Myanmar (Burma) and post Katrina Recovery Efforts <i>R: Oak Alley—4th Fl</i>			

10:30 AM - 12:00 NOON	Closing Plenary – Grass Roots GIS in the Recovery of New Orleans & URISA Annual Business Meeting <i>R: Grand A/B—5th Fl</i>					
-----------------------	---	--	--	--	--	--

URISA Registration – 5th Floor Grand Foyer
 Monday, October 6 – 1:00 – 5:00 PM
 Tuesday, October 7 – 7:00 AM – 6:00 PM

Wednesday, October 8 – 7:00 AM – 5:00 PM
 Thursday, October 9 – 7:00 AM – 5:00 PM
 Friday, October 10 – 7:30 AM – 12:00 PM

OCTOBER 7, 2008

Introduction to Public Participation GIS (PPGIS) <i>R: Salon 825 – 8th Fl</i>	LIDAR Concepts, Principals and Applications <i>R: Salon 828 – 8th Fl</i>	Public Data, Public Access, Privacy, and Security: U.S. Law and Policy <i>R: Salon 817-8th Fl</i>	Addresses and IS/GIS Implementation: Key to GIS Success <i>R: Grand Couteau – 5th Fl</i>	Building Quality Spatial Data <i>R: Oak Alley – 4th Fl</i>	GIS Strategic Planning <i>R: Grand B-5th Fl</i>
--	---	--	---	---	--

OCTOBER 8, 2008

Emergency Management & Homeland Security Emergency Management of the Virtual State <i>R: Oak Alley – 4th Fl</i>	Public Participation GIS (PPGIS) New Technologies: Enhancing PPGIS <i>R: Gallier – 4th Fl</i>	Data Acquisitions & Conversion Ground Control to Major Tom <i>R: Bayside C – 4th Fl</i>	Open Source and Open Standards Building Applications with Open Source Technologies <i>R: Oak Alley – 4th Fl</i>	Interactive Problem-Solving Track Strategic Communication Planning – Moving the Mountain <i>R: Grand Couteau – 5th Fl</i>
--	--	--	--	--

Resources & Environment Change Management <i>R: Grand Couteau – 4th Fl</i>	PPGIS PPGIS Practice in Elections <i>R: Oak Alley – 4th Fl</i>	Data Acquisitions & Conversions Going from Zero to 60 <i>R: Bayside C – 4th Fl</i>	Open Source and Open Standards Utilizing Google Maps/Earth as an Open Source API's <i>R: Nottaway – 4th Fl</i>	Strategic Communication Planning – Moving the Mountain <i>R: Grand Couteau – 5th Fl</i> <i>Continuation of previous session</i>
---	---	---	---	--

Natural Resources & Environment Water Resources/Demand <i>R: Gallier – 4th Fl</i>	Emergency Management and Homeland Security Disaster Response and Readiness - Take 2 <i>R: Bayside C – 4th Fl</i>		Unified Voice to Advocate Development of the National Spatial Data Infrastructure <i>R: Grand Couteau – 5th Fl</i>
--	---	--	--

OCTOBER 9, 2008

Emergency Management & Homeland Security Disaster Response and Readiness <i>R: Oak Alley – 4th Fl</i>	Data Acquisitions and Conversion Spatial Data Quality- Standards at Work <i>R: Bayside C – 4th Fl</i>	Data Acquisitions & Conversion Collecting Today For Tomorrow <i>R: Oak Alley – 4th Fl</i>	Infrastructure Infrastructure Lifecycle and Sustainability <i>R: Grand B – 5th Fl</i>	Spatially Enabling Your Enterprise <i>R: Grand Couteau – 5th Fl</i>
--	--	--	--	---

Public Health Issues and Challenges to Collecting Public Health Data in the Field <i>R: Grand Couteau – 5th Fl</i>	PPGIS Using PPGIS for Automating Policy Analysis <i>R: Nottaway – 4th Fl</i>	Data Acquisition and Conversion The Synergy of Sharing <i>R: Oak Alley – 4th Fl</i>	Infrastructure Transportation Decision Support Systems <i>R: Bayside C – 4th Fl</i>	Continuation of morning session <i>R: Grand Couteau – 5th Fl</i>
---	---	--	--	--

	Hot Topics GIS in K-12 Education <i>R: Grand Chenier – 5th Fl</i>	URISA Initiatives Address Standard Working Group Update <i>R: Bayside C</i>	Infrastructure New Concepts in Infrastructure Modeling <i>R: Nottaway – 4th Fl</i>	Continuation of morning session <i>R: Grand Couteau – 5th Fl</i>
--	--	--	---	--

OCTOBER 10, 2008

Infrastructure Infrastructure Management <i>R: Gallier – 4th Fl</i>	PPGIS Creating Collaborative Communities of Practice: Assessing the Impacts of PPGIS Work <i>R: Nottaway – 4th Fl</i>	Data Acquisitions & Conversion Shoring up Your Data for the Enterprise <i>R: Bayside C – 4th Fl</i>	A New Funding Model <i>R: Grand Couteau – 5th Fl</i>
--	--	--	--

CONFERENCE PROGRAM—WEDNESDAY

GEOSPATIALLY ENABLED
ENTERPRISE

Service-Oriented Architectures and Open Frameworks

Room: Bayside Ballroom A –4th floor

Service-oriented architectures and open frameworks provide technologies toward geospatial enterprise integration. Overcoming data ownership issues is also critical in overcoming obstacles in implementing enterprise GIS solutions.

Moderator: Luke Boggess, GISP, URS Corporation, Anchorage AK

Don't Shoot Me, I'm Just the Librarian: Data Ownership Fosters Enterprise Success
The Importance of an Open Framework for Managing Infrastructure Asset Data
A Spatial Analysis of California Broadband Availability

Greg Bury, Naval Air Engineering Station, Lakehurst, NJ
Michael Schlosser, Autodesk Canada Inc, Regina, SK Canada
Malcolm Adkins, GISP, Michael Baker Jr. Inc., Oakland, CA

NATURAL RESOURCES &
ENVIRONMENT

Land Use Change

Room: Gallier–4th floor

With an increase in population and need for developable land, GIS plays an integral role in tracking land use and analyzing environmental impacts. This session will explore and analyze change of land use to show urban sprawl and new areas of development.

Moderator: Tobias Wolf, GISP, HDR, Inc., San Diego, CA

Evaluating the Environmental Effects of Urban Sprawl Using Landscape Metrics
Updated Statewide Land Use Data Using Semi-Automated Methods for MA
Land Use Capability Mapping of Tropical Drained Peatlands

Michael Gilbrook, HDR Engineering, Orlando, FL
Sudha Maheshwari, Sanborn, Ann Arbor, MI
Joseph Olakunle Johnson, Ordnance Survey, Southampton, United Kingdom

PPGIS

PPGIS Practice in Elections

Room: Oak Alley–4th floor

Public policy is best served with fair and open elections. This session presents case studies of voting and campaigning in the election process.

Moderator: Carl Anderson, Fulton County, Atlanta, GA

Election Day Incident Mapping and Automated Analysis
Campaign Contribution Mapping and Analysis
Spoiled Ballots & Race: GIS and the Controversy Over Voting Technologies in Ohio

Megan Heckert, Avencia Incorporated, Philadelphia, PA
Megan Heckert, Avencia Incorporated, Philadelphia, PA
Mark Salling, GISP, Center for Community Solutions & NODIS, Cleveland, OH

DATA ACQUISITIONS &
CONVERSIONS

Going from Zero to 60

Room: Bayside Ballroom C–4th floor

From basic data needs to fine tuning established processes, you can collect information and propagate it out to your organization. See how these local departments are making it work.

Moderator: Keri Brennan, GISP, The Schneider Corporation, Indianapolis, IN

Crossing the Digital Divide
Evolution of a Geospatial Data Collection Utility: From Clipboard to Web Service
Leading Louisiana...Baton Rouge G.I.S.

Winchester Jordan and Conrad Comeaux, Lafayette Parish Assessor's Office, Lafayette, LA
Jeffrey Trudnak, GISP, Spatial Networks, Clearwater, FL
Warren Kron and Jose Villalobos, City of Baton Rouge Planning Commission, Baton Rouge, LA

OPEN SOURCE AND OPEN
STANDARDS

Utilizing Google Maps/Earth as Open Source API's

Room: Nottaway–4th floor

Open Source API's allows you to build Mashups easily. This session presents case studies of Google Maps/Earth applications.

Moderator: Jochen Albrecht, Hunter College, New York, NY

Utilizing Google Maps with Korean Online Mapping Webportal
Streaming ArcGIS data to Google Earth Through the Dynamic Generation of KML Data
Powering the GeoWeb: A Hands-On Survey of Protocols and Formats

Wansoo Im, Vertices LLC, New Brunswick, NJ
David Greene, AMEC, Nashville, TN
Ryan Cragg and Drew Rifkin, Safe Software Inc., Surrey, BC Canada

CONFERENCE PROGRAM—WEDNESDAY

INTERACTIVE TRACK

Strategic Communication Planning—Moving the Mountain (Part Two)

Room: Grand Couteau—5th floor

(Continuation of morning session)

The challenge we face together in URISA is the vast range of direct and indirect participants including: member jurisdictions; governing boards; related stakeholders groups; and decision-makers. While URISA has a strategy, we do not have a strategic communication plan to ensure achievement of our high-level objectives.

What will we be developing together?

- Identify three or four critical strategic objectives (or synthesis of objectives) that warrant targeted communications
- Create context descriptions and guiding principles associated with each objective
- Create central messages for each objective
- Describe how the objectives, when combined, achieve the signature capability of URISA (i.e., the business objective)
- Create a one-page summary of each central message to unify thinking and provide “Talking Points” (how we are all going to talk about this over the next year)
- An implementation plan and schedule covering the coming year

Once created, the Strategic Communication Plan is the communications roadmap to guide us all, and that everyone can have a role in implementing.

REFRESHMENT BREAK IN EXHIBIT HALL

3:30–4:00 PM

EDUCATIONAL SESSIONS

4:00–5:00 PM

CROSS-JURISDICTIONAL COLLABORATION

Cooperative Orthoimagery Acquisition

Room: Grand Ballroom A—5th floor

If the diverse business needs of governmental agencies using orthoimagery can be met, significant cost savings can be realized through collaborative efforts. Learn how two such efforts have successfully implemented cooperative orthoimagery acquisition programs.

Moderator: Greg Babinski, GISP, King County, Seattle, WA

We Can All Get Along - Creation of a Multi-Agency Cooperative Base Mapping Program
Managing a Regional Orthophoto Consortium: Project Management Tips & Tricks

Kim McDonough, GISP, Tennessee Department of Transportation, Nashville, TN
Matthew Krusemark, GISP, Denver Regional Council of Governments, Denver, CO

MANAGEMENT & PROFESSIONAL DEVELOPMENT

Update on URISA Initiatives

Room: Grand Chenier—5th floor

This session is designed to give an update on two core URISA Initiatives: GISCorps and GISCI. Attendees will hear updates on volunteerism in Mozambique and Sudan through the GISCorps program and strategies for applying for GISCI certification to become a GISP, the application review cycle and the renewal process.

Moderator: Dianne Haley, GISP, Alberta Energy Resources Conservation Board, Calgary, AB, Canada

GISCorps Projects and Activities in 2007–2008

Shoreh Elhami, GISP, Delaware County Auditor's Office, Delaware, OH
Mark Salling, GISP, Cleveland State University,
Dianne Haley, GISP, Alberta Energy Resources Conservation Board, Calgary, Canada

Ingrid Bruce, GISP, City of Rancho Cucamonga, CA

J. Allison Butler, GISP, AICP, Butler & Butler LLC, Orlando, FL

The GISCI Certification Program

PRIVACY & PUBLIC ACCESS

Santa Clara County Lawsuit: Implications to Public Geodata

Room: Grand Ballroom B—5th floor

Last year, the California First Amendment Coalition won a lawsuit against Santa Clara County, with the court ordering the County to provide its parcel basemap data for the cost of duplication, as required by the California Public Records Act. Or did they? Appeals have raised questions. This interactive session updates the issues and seeks your opinions.

Moderator: Steve Kinzy, GISP, ESRI, St. Charles, MO

Santa Clara County Lawsuit: Implications to Public Geodata

Bruce Joffe, GISP, GIS Consultants, Oakland, CA

CONFERENCE PROGRAM—WEDNESDAY

GEOSPATIALLY ENABLED
ENTERPRISE

GIS and Content Management Integration

Room: Bayside Ballroom A—4th floor

Geospatial technologies are now considered mainstream components within the overall enterprise IT framework and are increasingly used for a wide range of business process automation. This session will provide examples of integrating legacy property/tax data, utility infrastructure field data collection/inspection and adding geospatial representations to a document management system.

Moderator: Cindy Braddock, Boulder County Assessors Office, Boulder, CO

Integration of Geospatial Technology and Enterprise Content Management
Geospatially Enabling a Document Management System

Stephen Beck, GISP, Johnson, Mirmiran and Thompson, Baltimore, MD
Carl Anderson, Fulton County, Atlanta, GA

NATURAL RESOURCES &
ENVIRONMENT

Water Resources/Demand

Room: Gallier—4th floor

The increase in demand for potable water has a direct relationship to the increase in population. This session will focus on collaboration of stakeholders and GIS-based demand forecasts that assist with accurate water projections and allocation.

Moderator: Karen Stewart, GISP, ESRI Canada, Vancouver, BC

Water Resource Collaboration and GIS: The Nexus
Accurate Projections of Future Water Demands in Florida Using GIS-Based Population

Phyllis Thomas, Phyllis Thomas Consulting, Centennial, CO
Justin Saarinen, GISP, GIS Associates, Gainesville, FL

EMERGENCY MANAGEMENT
AND HOMELAND SECURITY

Disaster Response and Readiness - Take 2

Room: Bayside Ballroom C—4th floor

Up-to-date imagery and data provide critical information during a disaster. The use of oblique imagery for disaster mitigation and emergency response has proven value, but requires additional complimentary information to be of optimum benefit. Diverse data integration and system interoperability challenges will be explored via these presentations.

Moderator: Gordon Chinander, Metropolitan Emergency Services Board, St Paul, MN

United States Marine Corps Bases Use of Oblique Imagery
Emergency Operations Center's Incident Mapper

Art Kalinski, GISP, Pictometry International Corp, Guntersville, AL
Lee Hartsfield, GISP, Tallahassee-Leon County, Tallahassee, FL

INTERACTIVE TRACK

Unified Voice to Advocate Development of the National Spatial Data Infrastructure

Room: Grand Couteau—5th floor

This facilitator-led discussion revolves around making the best of our individual influence to move National Spatial Data Infrastructure (NSDI) objectives in our own jurisdictions. In addition, discussion from this panel will be provided to the appropriate parties to refine the currently developing NSDI strategic framework and draft action plan.

Facilitators:

Cy Smith, GISP, State of Oregon, Salem, OR

Danielle Ayan, GISP, Georgia Institute of Technology, Atlanta, GA

Networking Reception in the Exhibit Hall

5:00–7:00 PM

Head to the Exhibit Hall for refreshments and good conversation before heading out to explore New Orleans!

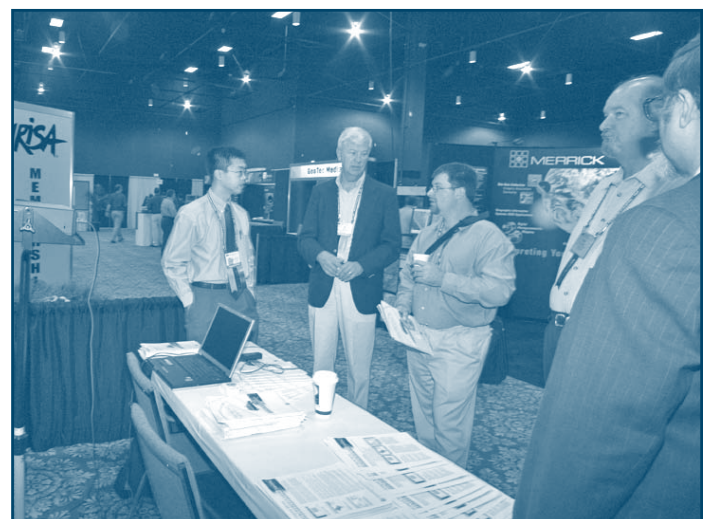
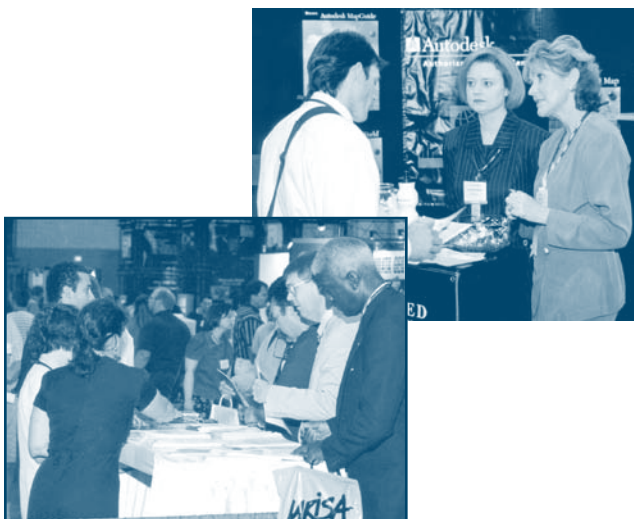

CONFERENCE PROGRAM—THURSDAY

7:00 AM–5:00 PM	Conference Registration Desk Hours
8:30–10:00 AM	Awards Breakfast
10:00–10:30 AM	Coffee Break in Exhibit Hall
10:00 AM–4:00 PM	Exhibit Hall Hours
10:30 AM–12:00 NOON	Educational Sessions
12:00 NOON–1:30 PM	Lunch on own and Exhibit Hours
1:30–3:00 PM	Educational Sessions
3:00–4:00 PM	Dedicated Exhibit Hour
4:00–5:00 PM	Educational Sessions
6:00–9:00 PM	Conference Social Event at Pat O'Brien's

8:30–10:00 AM

Awards Breakfast

Room: Grand Ballroom DE

Join URISA in honoring the outstanding members of the community along with the winners of the Exemplary Systems in Government (ESIG) Awards. A breakfast buffet will welcome you while we spotlight the outstanding work of your peers.

10:00–10:30 AM

Exhibit Hall

The exhibit hall is not open on Friday, so be sure to spend quality time getting your questions answered today!

EDUCATIONAL SESSIONS

10:30 AM–12:00 NOON

Efficiencies from Geospatially Enabled Enterprise Systems

Room: Grand Ballroom A–5th floor

Learn how outstanding regional and local enterprise systems are built and the types of efficiencies they produce that result in cost savings and good decision-making. This session features two 2008 ESIG Award winners.

Moderator: D. David Moyer, National Geodetic Survey, Madison, WI

An Operational Model of a Regional Geographic Information System

Dharmesh Jain, GISP, Regional Geographic Information System Agency, Grand Rapids, MI

Illinois Virtual Tollway (2008 ESIG Distinguished System)

Public Works GIS Viewer (2008 ESIG Single Process System Winner)

Kurt Lebo and Jeff Siegel, Illinois Tollway, Downers Grove, IL

Rogelio Matta and Joe Field, City of Fontana, CA

GEOSPATIALLY ENABLED ENTERPRISE

Understanding the Responsibilities of Surveyors and GIS Professionals

Room: Bayside Ballroom A–4th floor

This interactive panel discussion explores the continuing controversy surrounding the role of surveyors and GIS professionals and Federal government procurement rules. The session will highlight the need to further explain the NCEES Model Rules, which provide guidelines on respective responsibilities, to both professions.

Moderator: Al Butler, GISP, Butler & Butler LLC, Orlando, FL

Understanding the Responsibilities of Surveyors and GIS Professionals

Bruce Joffe, GISP, GIS Consultants, Oakland, CA

Eric Bohard, GISP, Clackamas County, Oregon

Dr. David Gibson, University of Florida, Gainesville, FL

MANAGEMENT & PROFESSIONAL DEVELOPMENT

CONFERENCE PROGRAM—THURSDAY

3D GIS

3-D(istribution) and Use

Room: Grand Chenier—5th floor

3D requires appropriate tools and data for successful implementation and distribution. This session looks at generating 3D imagery for viewing, integration with GIS, and the challenges of distributing spatial data (restricted, public safety, and general public consumption).

Moderator: Don Dittmar, GISP, Waukesha County, Waukesha, WI

Urban 3D GIS Models—Finding the Right Technology to Bring 3D to the Masses

Oblique Imagery 3D Models for Security

Practical Application of GIS Driven 3D Models for Contaminated Site Remediation

Tom Conry, Fairfax County, Fairfax, VA

Art Kalinski, GISP, Pictometry International Corp., Guntersville, AL

Jeffrey Laird, GISP, Grand Terre GIS Inc, Frankfort, KY

GEOSPATIALLY ENABLED ENTERPRISE

Data Integration & Enterprise Case Studies

Room: Gallier—4th floor

Government agencies at all levels are recognizing the need for geospatial system integration solutions that include the use of a master data management solution and system interfaces. This session provides case studies on geospatial enterprise solutions at the municipal and state levels.

Moderator: Heather Milton, GISP, URS Corporation, St Louis, MO

A System by the Cities for the Cities: The Quebec GOCité Initiative

Operation of a Multi-Platform Enterprise GIS - Let's Play Nice

Managing Change: Vermont's Enterprise GIS Initiative

Alain Dombrowski, Regional Manager, ESRI Canada, Montréal, Canada

Kim McDonough, GISP, Tennessee Department of Transportation, Nashville, TN

Stephen Sharp, GISP, Vermont Center for Geographic Information,

Waterbury, VT

EMERGENCY MANAGEMENT & HOMELAND SECURITY

Disaster Response and Readiness

Room: Nottaway—4th floor

Regional response and collaboration across multi-jurisdictional and multi-disciplinary boundaries to mitigate or respond to natural or man-made disasters is not only a concept, but a requirement.

Moderator: Alex Hepp, Pictometry International, Rochester, NY

Cooperative GIS Initiative for Regional Fire Protection and Disaster Planning

Marine Corps Leverages GIS and ArcGIS Server During the 2007 Southern California Wildfires

WebPuff™ - Automated Emergency Management Decision Support System

(2008 ESIG Distinguished System)

David Allen, GISP, City of Euless, Euless, TX

Michelle Boivin, GISP, Technology Associates International Corp, Chula

Vista, CA

Darius Kwiedorowicz, US Army Chemical Materials Agency, Aberdeen Proving

Ground, MD

DATA ACQUISITIONS AND CONVERSION

Spatial Data Quality- Standards at Work

Room: Bayside Ballroom C—4th floor

Documenting and understanding spatial data quality is critical component to every dataset. These presentations provide an insightful reflection upon "What have we achieved to date" through technical quality standards.

Moderator, Carol Hall, Metro Regional Services, Portland, OR

25 Years of Spatial Data Quality Research: Are We There Yet?

Sneak Preview: The New US Geospatial Metadata Standard

Documenting Cultural Resources in the Wake of a Disaster

Gary Hunter, University of Melbourne, Parkville, Australia

Lynda Wayne, GISP, FGDC-GeoMaxim, Asheville, NC

Sharon Shin, Federal Geographic Data Committee, Reston, VA

Deidre McCarthy, GISP, National Park Service, Washington, DC

DATA ACQUISITIONS & CONVERSION

Collecting Today For Tomorrow

Room: Oak Alley—4th floor

Preparing for future data needs involves planning now. Learning effective strategies now can enable your enterprise for the inevitable need.

Moderator: James Langtry, GISP, USGS, Lincoln, NE

Disaster Recovery Planning for GIS

Participant Statistical Areas Program for the 2010 Census

Economic Development Using GIS—from the City to State (Boston/Massachusetts)

Keith Fournier, GISP, Innovative Systems Design Ltd, Holland, OH

April Avnayim, US Census Bureau, Washington, DC

Juan Pablo Monzon, GIS Planning Inc, San Francisco, CA

INFRASTRUCTURE

Infrastructure Lifecycle and Sustainability

Room: Grand B—5th floor

Using an integrated approach to Asset Management throughout the lifecycle reduces the challenges in managing and maintaining an aging infrastructure with limited funding.

Moderator: Allen Ibaugh, GISP, Data Transfer Solutions, Orlando, FL

GIS, Engineering Design and the Interoperability Challenge

Building the Foundation for Sustainability

GIS-Based Infrastructure Management for Municipalities

Michael Schlosser, Autodesk Canada Inc., Regina, SK Canada

Karen Stewart, GISP, ESRI Canada, Vancouver, BC, Canada

Justin Gough, Novotx LLC, Clearfield, UT

CONFERENCE PROGRAM—THURSDAY

INTERACTIVE TRACK

Spatially Enabling Your Enterprise

Room: Grand Couteau—5th floor

Part 1 of 3 - (This track/session will continue throughout the day over 3 sessions)

Historically GIS has started out in a single department. Now that its value is realized, GIS has become a critical business process and is usually then aligned with corporate goals. Many conference attendees are now finding that their organizations want to include GIS in their business plan/strategy, mission, etc. This session is to help you understand how others are doing it, and how you might do it better.

This track is structured to provide an interactive learning experience, with presentations, break out groups and questions and answers from the panel members. Discussion will focus on the trials and tribulations of how to integrate GIS into an organization's primary strategic plan and subsequent operations.

We have carefully selected leaders and professionals that will share their real-world experiences with spatially enabling their enterprise.

David LaBranche, Office of the Deputy Undersecretary of Defense for Installations & Environment, Business Enterprise Integration Directorate, Arlington, VA

Kim McDonough GISP, GIS Coordinator for the Tennessee Department of Transportation

Wendy Ritchie, Director of GeoEdmonton at the City of Edmonton, Alberta, Canada

Lunch on Own—Exhibit Hall Open

12:00–1:30 PM

EDUCATIONAL SESSIONS

1:30–3:00 PM

EMERGENCY MANAGEMENT
& HOMELAND SECURITY

Postal Data & Google Maps Shine Light on New Orleans Recovery

Room: Grand Chenier—5th floor

After Hurricane Katrina emptied New Orleans and damaged 71% of the housing stock, government, nonprofits and neighborhood groups needed a way to track when and where people returned. Learn how the Data Center developed an alternative source of population data, created a Google Map application to deliver it, and most importantly, how groups are using the data to support their efforts in the recovery of New Orleans.

Moderator: Mark Salling, GISP AICP, Center for Community Solutions & NODIS, Cleveland, OH

Joy Bonaguro, Elaine Ortiz, and Allison Plyer, Greater New Orleans Community Data Center, New Orleans, LA

MANAGEMENT & PROFESSIONAL
DEVELOPMENT

Keys to Project and Program Success from Vision to Assessment

Room: Grand Ballroom B—5th floor

Leading a successful GIS Program or Project requires skills in a variety of key target areas. This session will discuss the roadmap for transition from GIS techie to GIS Lead, the use of GIS Visioning Workshops for community buy-in and strategies for effective GIS Review for more mature programs.

Moderator: Lynda Wayne, GISP, FGDC-GeoMaxim, Asheville, NC

Secrets to Project Management Success

Getting Executive Consensus—GIS Visioning Workshops

GIS Program Review: Moving Forward, Solving Problems, and Integrating Operations

Keith Fournier, GISP, Innovative Systems Design Ltd, Holland, OH

Stephen Kinzy, GISP, ESRI, St Charles, MO

Rebecca Somers, Somers-St.Claire, GIS Management Consultants, Fairfax, VA

DATA ACQUISITION AND
CONVERSION

3D Adds Volume

Room: Grand Ballroom A—5th floor

With the proliferation of accessible elevation data, 3D models are providing visual validation for construction plans, environmental concerns, and reusable topographic layouts. In maturing GIS Models the necessary inclusion of Z data, both above and below the surface is mounting. So, whether you are planning your municipal growth for the next decade or identifying power production sites for the next century, elevate your knowledge of how 3D information use is on the rise in your community and around the world.

Moderator: Xavier Lopez, Oracle Corporation, Nashua, NH

Analysing Inundation Areas Using 3D Analyst and Google Earth

Re-Usable, High-Detail 3-D Feature Content for Use in Google Earth™

Data Capture and Data Mining of Urban Air Pollution: The Building-Based Approach

Jonathan Posner, GISP, CDM - Camp Dresser & McKee Inc, Irvine, CA

Barry Bitters, GISP, University of West Florida, Navarre, FL

U. W. Tang, University of Macau, Peoples Republic of China (2008 Student Paper Award Recipient)

CONFERENCE PROGRAM—THURSDAY

GEOSPATIALLY ENABLED
ENTERPRISE

Master Address Data Management

Room: Gallier—4th floor

For government agencies, the use of shared, accurate and standardized address information is critical for seamless citizen service delivery. This session provides attendees with issues and challenges that jurisdictions face when implementing enterprise address solutions.

Moderator: Anne Payne, GISP, Wake County, Raleigh, NC

The Power of Enterprise Addressing Systems

Implementing Enterprise Addressing Solutions: Issues and Challenges

Deploying a GIS-Enabled, Centralized Addressing Authority in Mecklenburg County, NC

Hank Garie, GeoAnalytics Inc, Madison, WI

Mike Wierzbinski and Bill Campbell, Hart InterCivic, Austin, TX

Rhonda Buckner, Mecklenburg County, Charlotte, NC

Mike Wierzbinski, and Bill Campbell, Hart InterCivic, Lafayette, CO

GIS IN PUBLIC HEALTH

Approaches and Challenges to Collecting Geospatial Public Health Data in the Field

Room: Bayside Ballroom A –5th floor

This session will discuss methodologies for collecting more relevant qualitative and quantitative health-related spatial data, using freely available open source web-based tools, both domestically and internationally.

Moderator: Mary Tsui, Land Systems Group, Monterey, CA

Facilitating GIS Usage with Open-Source Web-Based APIs and Services

Reducing Disparities in Health Outcomes: A Local Spatial-Ecological Approach

Stormwater Runoff, Catch Basin Biology and Mosquitoes in an Urban Area

Daniel Goldberg, University of Southern California, Los Angeles, CA

Jacqueline Mills, University of Southern California, Los Angeles, CA

Marilyn Ruiz, University of Illinois, Urbana, IL

PPGIS

Using PPGIS for Automating Policy Analysis

Room: Nottaway—4th floor

Automating policy analysis improves effectiveness of public input. This session visits ways in which this has been implemented.

Moderator: Laxmi Ramasubramanian, Department of Urban Affairs and Planning, Hunter College, New York, NY

A Construction of Test Bed for Spatially Integrated Online Social Survey System

Role of Participation in the Development of MDPSS

Envisioning Sustainable Urban Neighborhood

Ko Ko Lwin, University of Tsukuba, Tsukuba, Japan

Manoj Kumar Roy, Queen's University Belfast, United Kingdom

Earl Bossard, San Jose State University, Davis, CA

DATA ACQUISITION AND
CONVERSION

The Synergy of Sharing

Room: Oak Alley—4th floor

As the economy tightens our purse strings, the need for smooth data transitions from one department to another is becoming a necessity instead of a bonus. From standardized naming schemas to enterprise conscious analysis results, forward thinking modeling is trimming the fat off of lumbering data flows and providing leaner procedures for quicker results. This session will describe systems that leverage geospatial data from disparate sources into an enterprise solution for which they are data stewards.

Moderator: Tim Hu, Teranet Inc., Toronto, ON Canada

A Watershed Modeling System—Bringing the Models Together

Conflate or Die - Insourcing for a Stronger Enterprise

Maximizing Value Extraction From Spatial Assets at USDA—APFO

Previn Wong, San Antonio River Authority, San Antonio, TX

Garrett Dunwoody, San Mateo County ISD, Redwood City, CA

Ken Melero, SPADAC, Inc, McLean, VA

INFRASTRUCTURE

Transportation Decision Support Systems

Room: Bayside Ballroom C—4th floor

GIS is being used as decision support systems for various transportation needs, such as performing economic feasibility, cost benefit analysis and logistics, required to manage, maintain and develop capital improvement planning for transportation infrastructure.

Moderator: Hilary Perkins, GISP, AICP, East-West Gateway Council of Governments, St. Louis, MO

The Benefits of Dynamic Segmentation to Local Government for Road Analysis

Developing a Decision Support System for the Korean Expressway Corporation

Case Study: Ohio Franklin County Engineer's Snow Plow Routing Project

Bruce Aquila, Intergraph Corp, Huntsville, AL

Wendy Ritchie, City of Edmonton, Edmonton, AB, Canada

Wansoo Im, Vertices LLC, New Brunswick, NJ

Craig Schorling, GISP, Columbus, OH



MARK YOUR CALENDAR!

URISA Leadership Academy

December 8-12, 2008

Seattle, WA

CONFERENCE PROGRAM—THURSDAY

INTERACTIVE TRACK

Spatially Enabling Your Enterprise

Room: Grand Couteau-5th floor

Part 2 of 3 - (This track/session will continue throughout the day over 3 sessions)

See 10:30 AM session (on page 29) for description.

EDUCATIONAL SESSIONS

4:00–5:00 PM

CROSS-JURISDICTIONAL COLLABORATION

A Business Case for Data Sharing

Room: Grand Ballroom A-5th floor

This panel will talk about best practices in data sharing, including the use of local parcel data to support western wild fires. Responding to emergencies is one of the most important business drivers for data sharing. State agencies play an important role in pre-deploying data that can be made available for sharing. These issues will be presented and discussed.

Moderator: Lisa Lubeley, GISP, Dudek Inc., Encinitas, CA

Data Sharing For a Purpose: A Business Case for Data Sharing

Anne Payne, GISP, Wake County GIS, Raleigh, NC

Nancy von Meyer, GISP, Fairview Industries, Pendleton, SC

David Tulloch, Rutgers, The State University of New Jersey, New Brunswick, NJ

MANAGEMENT & PROFESSIONAL DEVELOPMENT

Managing GIS Projects with Agile Practices

Room: Bayside Ballroom A-4th floor

With all the buzz about agile practices in the GIS community these days, it's easy to get lost in the jargon and clutter. Very simply, agile practices iteratively and incrementally deliver high quality, valuable, working software and GIS products to customers. This session will focus on defining what agile practices are and how to apply them within GIS organizations.

Moderator: Mark Sievers, Sievers & Associates LLC, Altamonte Springs, FL

Managing GIS Projects with Agile Practices

Allen Ibaugh, GISP and Jason Amadori, GISP, Data Transfer Solutions,

Orlando, FL

URISA INITIATIVES

How to Make the Most of URISA Membership

Room: Oak Alley-4th floor

Find out from URISA members how they have made the most of their membership in URISA. Learn about volunteer opportunities and typical volunteer roles to leadership. Making the most of your membership and your Return On Investment.

Dave Hawker, Winchester Jordan and others

GEOSPATIALLY ENABLED ENTERPRISE

Capital Investment Planning

Room: Grand Ballroom B-5th floor

The development and implementation of a Capital Improvement Plan (CIP) involves collaboration and information synthesis from multiple lines of business within an agency from budgeting and finance to construction project management. This session exposes how geospatial technologies, web portals and reporting facilitate are used to develop solutions for CIP information synthesis.

Moderator: Phyllis Thomas, Phyllis Thomas Consulting, Centennial, CO

Spatially Enabled Portal System for CIP Project Management

Bringing Infrastructure and Urban Planning Data Using a "Geo-Portal"

Harry Poulter, CDM - Camp Dresser & McKee Inc, Falls Church, VA

Marc Andre Paquin, Geomap GIS America, Saint Bruno, QC Canada

HOT TOPICS

GIS in K-12 Education

Room: Grand Chenier-5th floor

Learn about K-12 education initiatives underway at Ramapo College, the University of Wisconsin and at the National Park Service. Then participate in an interactive panel discussion to discuss the future of GIS education.

Presenter and Facilitator: Wansoo Im, Vertices LLC, New Brunswick, NJ

Panel Participants: Ingrid Bruce, City of Rancho Cucamonga, CA

Others to come

CONFERENCE PROGRAM—THURSDAY

URISA INITIATIVES

Address Standard Working Group Update

Room: Bayside Ballroom C—4th floor

This session will give a detailed overview of implementing address quality tests and discuss address standard implementation issues. Additionally, there will be an introduction to the Global Address Standard Initiative.

Moderator: Sara Yurman, Spatial Focus, Inc., Decatur, GA
Address Standard Working Group Update/International Addressing Standard

Carl Anderson, Fulton County, Atlanta, GA
Hilary Perkins, GISP AICP, East-West Gateway Coordinating Council, St. Louis, MO
Martha Wells, GISP, Spatial Focus, Inc., Birmingham, AL
Sara Yurman, Spatial Focus, Inc., Decatur, GA

INFRASTRUCTURE

New Concepts in Infrastructure Modeling

Room: Nottaway—4th floor

GIS modeling concepts are used to calculate supply, capacity, and demand as well as incorporate external factors that affect asset condition and quality enabling decision makers to project impacts on existing infrastructure and develop new requirements.

Moderator: Karl von Schlieder, City of Carlsbad, CA
GIS and CAD Data Integration for Calculating Runoff from Impervious Surfaces
Using GIS to Map Recreational Trails for Small Municipalities (Pike Road, AL)

Isabel Canete-Medina, cmQue inc, Evanston, IL
Mark Curry, Auburn University Urban Modeling Lab, Auburn, AL

INTERACTIVE TRACK

Spatially Enabling Your Enterprise Panel

Room: Grand Couteau

Part 3 of 3 - (This track/session will continue throughout the day over 3 sessions)

See 10:30 AM Session for Description

Conference Social Event

6:00–9:00 PM

Come be part of what has become a fun tradition at URISA Annual Conference & Exposition! The Conference Social Event brings conference attendees together to Jazz it up at one of New Orleans's newest venues with the oldest reputation! "Pat O's on the River", part of the famous Pat O'Brien's, is situated in the Jax Brewery Millhouse along the majestic Mississippi River. Enjoy a fun-filled evening of great food, beverages and the foot tapping, lagniappe tossing tunes of the Joe Simon Trio Jazz Band! **Be sure to bring your conference ticket to be admitted.** If you didn't pre-register for this event, be sure to visit the Registration Desk before 5pm on Thursday.

It'll be a wondermous time, we gaw-ron-tee!

Pat O's on the riverfront is a short, enjoyable 5 block walk from the hotel and 4 blocks from the French Quarter! However, URISA will provide a shuttle to run back and forth between the Sheraton New Orleans and Pat O's. The first shuttle will leave at 5:45 PM and leave the Sheraton every 15 minutes between 6:00 PM and 7:00 PM. The shuttle will run as needed until 8:00 PM then it will start returning to the hotel every 15 minutes until it's last trip from Pat O's at 9:15 PM.

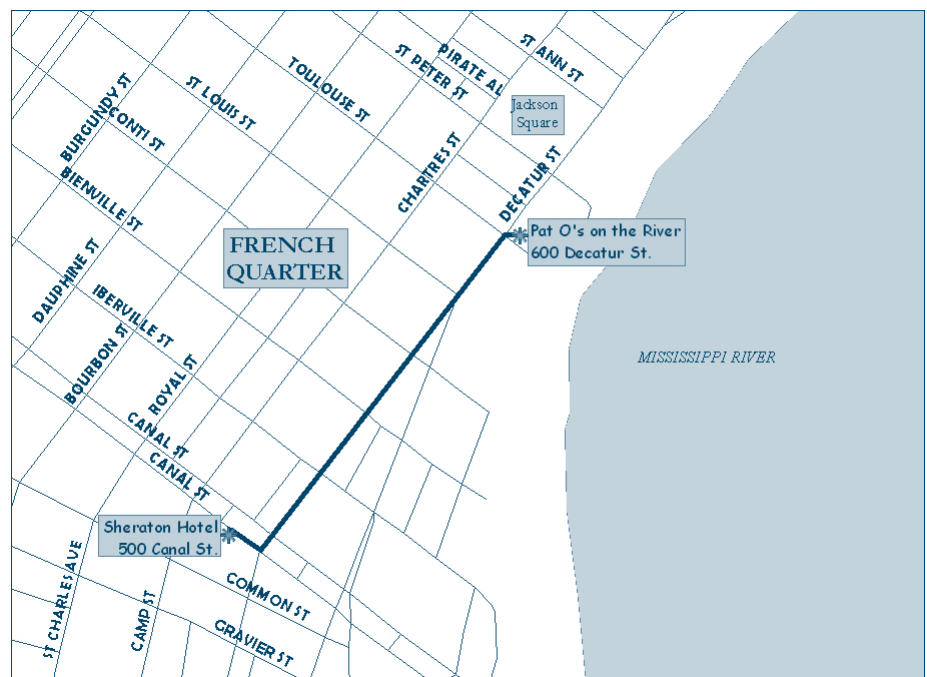

CONFERENCE PROGRAM—FRIDAY

7:30 AM–12:00 PM	Conference Registration Desk Hours
8:30–10:00 AM	Educational Sessions
10:30 AM–12:00 PM	General Session & URISA Annual Business Meeting
1:00 PM–5:00 PM	New Orleans Charity Event

EDUCATIONAL SESSIONS

8:30–10:00 AM

PUBLIC HEALTH & SAFETY

Case Studies in GIS and Public Health

Room: Bayside Ballroom A–4th floor

These presentations, using geospatial technologies and processes to support local Public Health agencies, illustrate the significance of spatial analysis in operational response.

Moderator: Marilyn Ruiz, University of Illinois, Urbana, IL

Using Spatial Tools to Examine Space–Time Dynamics of Mite Bite Outbreaks
Spatiotemporal Indexing with the M-Tree

William Syversen, DuPage County, Wheaton, IL
John Finigan, University of New, Orleans, Metairie, LA
Elias Ioup, Naval Research Laboratory, Stennis Space Center, MS
Scott Christman, ESRI, Redlands, CA

Geographic Information Systems & Local Health Department Business Processes

MANAGEMENT & PROFESSIONAL DEVELOPMENT

Identifying and Evaluating Geospatial Competencies

Room: Grand Chenier–5th floor

The occupations and employers that rely upon geospatial technologies are increasingly numerous and diverse. This diversity is reflected in the variety of mechanisms that have been developed to assure the competence of geospatial practitioners. This panel discussion will consider several initiatives concerned with identifying and assessing individual mastery of core geospatial competencies.

Moderator: Will Craig, GISP, University of Minnesota, Minneapolis, MN

Identifying and Evaluating Geospatial Competencies

David DiBiase, GISP, Penn State University, University Park, PA
J Allison Butler, GISP, AICP, Butler & Butler LLC, Orlando, FL

EMERGENCY MANAGEMENT & HOMELAND SECURITY

GISCorps Volunteers Assist in Post Cyclone Disaster in Myanmar (Burma) and Post Katrina Recovery Efforts

Room: Oak Alley–4th floor

In May and June of 2008 over 30 GISCorps volunteers provided their GIS expertise to the UN's Operational Satellite Applications Programme (UNOSAT). They collected thousands of features from pre and post cyclone satellite imageries which were made available to many aid and humanitarian agencies to be used in a variety of disaster response applications. Volunteers will share their experiences with the audience. Another presentation will be given by David Allen who assisted Gulf Coast Community Design Studio in a post Katrina recovery effort in Biloxi, MS.

Moderator: Shoreh Elhami, GISP, Delaware County Auditors Office, Delaware, OH

Presenters to include:

Tom Ponte, FEMA, Bend, OR - GISCorps Volunteer

Ingrid Bruce, City of Rancho Cucamonga, CA - GISCorps Core Committee Member

David Allen, GISP, City of Euless, TX - GISCorps Volunteer

PPGIS

Creating Collaborative Communities of Practice: Assessing the Impacts of PPGIS Work

Room: Nottaway–4th floor

This session will explore the ways in which PPGIS tools, methods, and practices can collectively improve communication between different groups. It will also highlight some of the short and long term benefits of creating collaborative communities of practice.

Moderator: Kevin Sato, Cottonwood Heights City, UT

Surveying the Extent of PPGIS Practice: Preliminary Findings and Directions for Future Research

Richard Amanna and Laxmi Ramasubramanian, Department of Urban Affairs and Planning, Hunter College, New York, NY

Data Basin: PPGIS Tools that Bridge the Divide Between Scientists, Policy Makers & Citizens

Josh Knauer, Riza Labs, Pittsburgh, PA

Using PPGIS Tools in Small Town Planning:

A Presentation of Local Government Uses of PPGIS and Lessons Learned

Judy Colby-George, Spatial Alternatives, Inc., Yarmouth, ME

CONFERENCE PROGRAM—FRIDAY

DATA ACQUISITIONS & CONVERSION

Shoring up Your Data for the Enterprise

Room: Bayside Ballroom C—4th floor

Build it once, use it many times. These three perspectives demonstrate how disparate data can be integrated and distributed widely.

Moderator: Nelda Sisler-Buck, Delaware County, Delaware, OH

New Technologies for Parcel Fabric Management

Limited Funding, Not Enough Staff Time & 56 Comp Plans –

Building a Geospatial Regional Zoning Layer for the First Time

Kentucky Landscape Census

Brent Jones, ESRI, Redlands, CA

Robin Reilley, Denver Regional Council of Governments, Denver, CO

Sudha Maheshwari, Sanborn, Ann Arbor, MI

INFRASTRUCTURE

Infrastructure Management

Room: Gallier—4th floor

Use of holistic approaches in GIS to capture, analyze and evaluate various physical assets to better manage living conditions, safety and infrastructure.

Moderator: Al Little, City of Hamilton, ON, Canada

A Holistic Approach to Infrastructure Mapping and Updates

Connectivity and Accessibility Measurement of Facilities in Residential Complex

Road Sing Management System

Nailishebo Kaunda, City of Huntsville, Huntsville, AL

Hoon Chang and Hyunji Seo, Yonsei University, Seoul, Korea

Jeyoon Woo and Kyusoo Chong, Korea Institute of Construction Technology,

Goyang, Korea

INTERACTIVE TRACK

A New Funding Model

Room: Grand Couteau—5th floor

This highly interactive panel session will present results of collaborative national effort to define a mechanism for tracking GIS benefits to various levels of Government. A proposed method will be presented, followed by discussion.

A New Funding Model for GIS Development

Cy Smith, GISP, State of Oregon, Salem, OR

10:15–11:30 AM

GENERAL SESSION

Closing Plenary Session - Grass Roots GIS in the Recovery of New Orleans

Room: Grand Ballroom A/B—5th floor

The ability of a disaster to motivate citizens to work for change cannot be underestimated. In 2005, storm surge from Hurricane Katrina caused the failure of several levees in New Orleans. In all, 80% of the city was flooded, and the recovery from this disaster has been long and hard.

Throughout the city, citizens frustrated with the pace of recovery have organized themselves and their neighborhoods in an effort to rebuild and return to normalcy. Many neighborhood groups benefited from volunteers who, by using GIS, were able to help pin-point the areas of greatest need and secure much needed rebuilding resources.

This session will present the work of two of those neighborhood groups, the Broadmoor Improvement Association and the panel discussion about how GIS is helping them to make spatial sense of their recovery. Also on the panel will be representatives of two local non-profit organizations dedicated to helping citizens find and use GIS data to support their grass roots efforts to improve the quality of life in New Orleans.

Moderator: Kathrine Cargo, GISP, New Orleans Parish Communications District, New Orleans, LA

Panelists:

Denice Warren, Greater New Orleans Community Data Center

Alan Gutierrez, Community Organizer

Stephen Tremaine, Broadmoor Improvement Association

11:30 AM–12:00 NOON

URISA Annual Business Meeting

CONFERENCE PROGRAM—FRIDAY

CHARITY EVENT

Hopefully, you've arranged your travel schedule to include the URISA Charity Event with the Beacon of Hope Resource Center.

The center is "...a grassroots organization taking proactive measures to rebuild neighborhoods using volunteer effort and attempting to bring back people to neighborhoods that are struggling to recover. Through generous donations and the efforts of volunteers we have had an immediate impact on the surrounding community," says Beacon's Director of Volunteers Liz Widener.

URISA volunteers will be bussed to the Gentilly area of New Orleans, which was a particularly hard-hit area following Katrina. Because of the breaches and the failure of levees in the surrounding area, floodwaters submerged most homes in the area to the roofline or higher.

Slowly but surely, residents are making their way back to the area to repopulate the neighborhood. To make their home-coming a bit easier, we will be cleaning and cutting down overgrown lots, picking up debris and cleaning storm drains throughout the Gentilly area. Beacon of Hope will provide tools (shovels, rakes, garbage bags). Bring workgloves if you have some and dress appropriately (as if you were doing yardwork at home).

Transportation will leave the Sheraton promptly at 1:00 PM (please be ready to board the bus at 12:45) and will return at 5:00 PM.

URISA extends special thanks to Pictometry for sponsoring the shuttle service to and from the charity event as well as the refreshments available on our way back. Pictometry is proud to help New Orleans and the rebuilding of its neighborhoods by helping those who help others.



Web & Database Applications • Geographic Information Systems
Transportation • Video & Multimedia • Asset Management



Corporate Headquarters: 4037 Avalon Park Boulevard East • Orlando, Florida • 32828 • 407.382.5222

Regional Offices:

Tampa, Florida • Jacksonville, Florida • Naples, Florida • Raleigh, North Carolina
Chicago, Illinois • San Antonio, Texas • Denver, Colorado • Fort Collins, Colorado • Boston, Massachusetts

EXHIBITORS

Exhibit Hall

An integral part of your URISA Annual Conference experience is the Exhibit Hall.

Where else can you:

- Get hands-on demonstrations of the latest technology available?
- Have face-to-face conversations with multiple suppliers all in one place?
- Compare and contrast potential solutions that will make your jobs easier?

The Exhibit Hall is open during these hours:

Wednesday, October 8, 2008

10:00 AM–7:00 PM

Networking Reception–5:00–7:00 PM

Thursday, September 28, 2006

10:00 AM–4:00 PM

Note that the exhibit hall is not open on Friday...so don't wait until then to visit the vendors!

Be sure to set aside enough time to network with these important organizations:

Exhibitor Directory

Caliper Corporation

CDM - Camp Dresser & McKee Inc.

Data Transfer Solutions

EnerGov Solutions LLC

ESRI

Facet Technology Group

Federal Geographic Data Committee

Geo-3D Inc

GEOMAP GIS America

GeoSpatial Experts

GISCI

Hart InterCivic

iLOOKABOUT Corp

Michael Baker Corporation

National Geographic Survey / NOAA

Orion Technology Inc.

Pictometry International Corp

Pinnacle Mapping Technologies Inc

Safe Software, Inc.

TerraGo Technologies

TeachMeGIS

University of Denver

WE Upjohn Center for the Study of Geographical Change

Vertices/GIS4Kids

Yotta MVS

Caliper Corporation

1172 Beacon Street, Suite 300

Newton MA 02461-9926

P: 617-527-4700

F: 617-527-5113

www.caliper.com

Caliper Corporation, founded in 1983 and headquartered in Newton, MA, is a technology leader in the development of geographic information systems (GIS) and transportation software. Caliper is the developer of TransCAD® transportation planning GIS software; Maptitude®, the intelligent mapping solution for business, government, and education; and TransModeler®, a powerful and versatile traffic simulation package.

Booth 301

CDM-Camp Dresser McKee Inc.

50 Hampshire Street

One Cambridge Place

Cambridge, MA 02139

P: (617) 452-6353

F: (617) 452-8353

Key Contact: Stephen Keen, GISP

www.cdm.com

Booth 414

CDM provides professional consulting services that address every phase of the GIS lifecycle. We offer a wide range of services to public, private, and utility clients; including planning, data conversion, organizational development, applications development, systems integration, and program management. Our project teams help define GIS requirements, establish appropriate funding vehicles, design network and data infrastructure, and build spatially-enabled productivity tools. CDM has over 3,700 staff in more than 100 offices worldwide.

Data Transfer Solutions

4037 Avalon Park Blvd E.

Orlando, FL 32828

P: 407-382-5222

www.edats.com

Booth 307

Data Transfer Solutions, LLC—innovative, technology-based solutions in:

- GIS and Internet Mapping—Internet mapping and ESRI
- Web and Database Applications—information systems, data analysis, customize software
- Asset Management—AMS collection and database for Asset, Facility and GIS challenges
- Multimedia and Video—Full-service video production
- Training—CD and on-line training

EnerGov Solutions LLC

2763 Meadow Church Road, Suite 220

Duluth, GA 30097

P: 888-355-1093

F: 678-474-1002

www.energov.com

Booth 406

GIS-centric enterprise software solutions that manages permitting, planning, licensing, enforcement, and regulatory land-use operations. EnerGov utilizes state-of-the-art technology to develop intelligent systems tailored around the specific needs and processes of local and state government agencies regulating land use across the United States.

ESRI

380 New York Street
Redlands, CA 92373
P: 909-793-2853
F: 909-793-5953
www.esri.com

ESRI® leads the international geographic information system (GIS) software industry with innovative solutions that help more than 300,000 organizations create, manage, visualize, and analyze information. Our clients use ArcGIS® software to unlock the spatial component of their data and quickly make effective decisions. ArcGIS is an integrated family of products for use in desktops, servers, or custom applications; in the field; or over the Web. www.esri.com

Facet Technology Corp

6517 City West Parkway
Eden Prairie, MN 55344
P: 952.944.1839
F: 952.944.1839
E: sales@facet-tech.com
www.facet-tech.com

Facet Technology Corporation is a leading developer of technology solutions for efficiently gathering and utilizing roadway information—for infrastructure and asset management, digital mapping and navigation, parcel tagging and intersection imagery—through capture of digital, ground-based, street-level imagery, and extraction of point and linear attributes from that imagery.

Federal Geographic Data Committee

12201 Sunrise Valley Drive, MS 590
Reston, VA 20192
P: 703-648-4150
F: 703-648-5755
www.fgdc.gov

The Federal Geographic Data Committee (FGDC) is an interagency committee that promotes the coordinated development, use, sharing, and dissemination of geospatial data on a national basis. This nationwide data publishing effort is known as the National Spatial Data Infrastructure (NSDI), a physical, organizational, and virtual network designed to enable the development and sharing of this nation's digital geographic information resources. FGDC activities are hosted by the National Geospatial Programs Office (NGPO) of the U.S. Geological Survey.

Geo-3D Inc

9655 Ignace Street, Suite L
Brossard, Quebec
Canada J4Y 2P3
T: 450-659-2333
Tollfree: 1-866-904-3633
F: 450-659-2339
www.geo-3d.com

GEO-3D is a leader in georeferenced data acquisition, analysis and extraction hardware and software solutions. By utilizing advanced photogrammetry and an array of integrated sensors, GEO-3D has delivered efficient, safe and cost-effective solutions for large-scale projects for multiple users. New

Booth 201

technologies such as integrating lasers for automation are continually being developed to increase productivity, provide users with timely and accurate enterprise data, minimize road crew exposure and create robust information products that serve multiple uses.

GEOMAP GIS America

1440 Hocquart, Suite 220
Saint-Bruno (Quebec) Canada J3V 6E1
P: 450-461-1158
F: 450-461-1159
www.geomapgis.ca

GEOMAP has been developing and integrating systems based on Autodesk since 1989. The company is an Autodesk Systems Center, an Autodesk Registered Developer and an Authorized Autodesk Solution Provider. Expert in deploying GIS applications in large organizations, municipalities and government institutions, GEOMAP integrates multi-user architectures on an intranet or Internet using web and open source technologies. The GEOMAP GIS unique technology, built on AutoCAD, AutoCAD Map and Autodesk MapGuide, allows for the building of an information system that brings together all the assets that an organization wishes to manage in computerized plans

GeoSpatial Experts

12000 N. Washington
Suite 385
Thornton, CO 80241
P: 303-255-2908
F: 303-362-7129
www.geospatialexperts.com

GeoSpatial Experts developed of GPS-Photo Link, software that maps your photos. GPS-Photo Link creates ESRI Shape Files, Google Earth files, and web pages with watermarked photographs and maps. GeoSpatial Experts resells the Ricoh GPS enabled digital camera. ArcPad edition also available.

GISCI

1460 Renaissance Drive
Suite 305
Park Ridge, IL 60068
www.gisci.org

Interested in finding out more about GIS Professional Certification? More than 2,400 of your peers have already become certified via the GISCI program. Information on certification and/or recertification and the grandfathering dates are available at the GISCI Booth.

Booth 403**Booth 313****Booth 411****Booth 407****Booth 213****Booth 317**

EXHIBITORS

Hart InterCivic

15500 Wells Port Drive
Austin, TX 78728
P: 800-223-4278
F: 800-831-1485
www.hartintercivic.com
info@hartic.com

Hart InterCivic is a leading provider of Election and Geo-content solutions. The Hart Vantage™ products enable state and local governments to streamline operations, make better decisions and adapt quickly to evolving needs by leveraging GIS technologies to dramatically improve the management, availability and quality of location-based information across the enterprise. Hart's business values are centered on heritage, integrity, reliability and personalized customer service.

iLOOKABOUT Corp

383 Richmond Street
Suite 408
London, ON N6A 3C4 Canada

iLOOKABOUT StreetScape's spherical imagery, Geo-coded 180 degree panoramic photo's, captured every 15 feet of every public thoroughfare, provides unique street insight. The comprehensive database of smart images is built for professionals requiring accuracy in decision making and operational efficiency. iLOOKABOUT StreetScape provides dramatic cost savings and greatly enhances customer service by bringing visual knowledge right to the user's desktop.

Michael Baker Corporation

4431 North Front Road, Second Floor
Harrisburg, PA 17110
P: 717-221-2031
F: 717-234-7611
www.mbakercorp.com/gis

The Michael Baker Jr., Inc. (Baker) Geospatial Information Technologies Service Area provides complete geospatial services including planning, AM/FM and GIS consulting, needs assessments and technology implementation, photogrammetric mapping, digital orthophotography, data conversion, scanning, remote sensing and GPS and conventional field inventory and surveys. Baker's GIS/GPS Field Mapping software GeoLink® provides real-time data collection with GPS accuracy.

National Geodetic Survey / NOAA

1315 East West Highway
Silver Spring, Maryland 20910-3282
P: 301-713-3242
F: 301-713-4172
www.ngs.noaa.gov

NOAA's National Geodetic Survey (NGS) defines and manages the National Spatial Reference System - the consistent, high-accuracy framework for positioning, mapping, charting, and engineering activities throughout the United States. NGS is a global leader in developing new surveying method and setting for precise positioning surveys.

Booth 400

Orion Technology, Inc

A division of Rolta Canada Ltd.
80 Whitehall Drive Suite #3
Markham, Ontario
CANADA L3R 0P3
www.oriongis.com

Orion Technology, a division of Rolta Canada Ltd., a product development and solution integration company, is enjoying growing support in the global GIS community as a standard for web based mapping. Orion's award-winning flagship product OnPoint™ provides out-of-the-box advanced functionality and security, integration with Pictometry and Microsoft Virtual Earth, and unparalleled data and application integration features. OnPoint is fully configurable through an intuitive administration tool and allows you to connect your spatial and non spatial data with no programming required.

Booth 417

Pictometry International Corp

100 Town Centre Drive, Suite A
Rochester, NY 14623
P: 585-486-0093 x 225

Pictometry is the world leader in oblique angle aerial imagery for Public Safety, Planning, GIS and Property Assessment applications. Images are high-resolution, full-color, geo-referenced and support measurements directly on the imagery. Client/Server and Web-based deployments are available.

Pinnacle Mapping Technologies, Inc

Ryan King-rmking@pinnaclemapping.com
P: 317-585-2011
www.pinnaclemapping.com

Digital Aerial Photography, Topographic and Planimetric Mapping, LIDAR, Geodatabase Design, and GIS services, Digital Orthophotography, Film scanning and quality control/quality Assurance services.

Safe Software, Inc

Suite 2017, 7445
132nd Street
Surrey, BC V3W 1J8
Canada
P: 604-501-9985
F: 604-501-9965
www.safe.com

Safe Software Inc. is the global leader in spatial ETL (extract, transform and load) technology solutions that help GIS professionals and organizations solve their data interoperability challenges. Safe Software's FME platform makes it easy for users to efficiently use and leverage their spatial data in any format or application - while improving efficiency, reducing costs and lowering risks.

Booth 312

Booth 401

Booth 415

Booth 315

TerraGo Technologies

1600 Parkwood Circle Suite 300
 Atlanta, GA 30339
 Phone- (678) 391-9700
 Fax- (678) 391-9701
<http://www.terragotech.com>

As the pioneer of geo-enabled PDFs, TerraGo Technologies removes technology barriers to broaden the access and application of geospatial data. TerraGo's advanced tools and technology leverage PDF and the Adobe platform to enable geospatial applications that meet the needs of all types of end users, regardless of GIS expertise. Providing complete end-user focus, unmatched GeoApp expertise and geospatial data source independence, TerraGo makes it cost effective to easily build and deliver GeoApps for use by anyone, anywhere.

TeachMeGIS

Inner Corridor Technologies, Inc. / TeachMeGIS
 3000 Wilcrest, Suite 195
 Houston, TX 77042
 P: 713-278-7883
 F: 713-278-7399
www.TeachMeGIS.com

TeachMeGIS, an ESRI Authorized Partner Education Center, offers GIS courses in Houston, Baton Rouge and New Orleans as well as private and custom classes all over the nation. Five of the 8 ESRI Authorized Instructors on our team, all of whom have between 8 and 20 years of GIS experience, have been ranked among the top ESRI Training Partners in the nation. We specialize in custom GIS courses, written for your company or your industry.

University of Denver

2211 South Josephine Street
 Denver, CO 80208
www.universitycollege.du.edu
mark.guthrie@du.edu
 P: 303-871-7582
 F: 303-871-3070

"The University of Denver's school of professional and continuing studies, University College, and the Department of Geography offer a Master of Science in Geographic Information Science delivered entirely online. Additionally, University College offers a certificate of advanced study in GIS both online and on-site at its Denver campus. This program is highly regarded due to its curriculum, faculty, state-of-the-art labs, and the fact that the skills and strategies you learn in class are immediately applicable."

Booth 412**W.E. Upjohn Center for the Study of Geographical Change**

1100 Welborn Hall
 Western Michigan University
 Kalamazoo, MI 49008-5388
 P: 269-387-3364
 F: 269-387-3582

The W.E. Upjohn Center for the Study of Geographical Change at Western Michigan University specializes in producing digital facsimiles (exact copies) of large format documents (maps, drawings, aerial photos) in color, grayscale, or black/white. Rare and delicate materials are imaged non-destructively. Bound, folded, and torn documents can also be imaged. We serve any public or private agency. Call us before you have a document loss crisis. You can't afford not to.

Booth 409**Booth 413****Vertices/GIS4Kids**

317 George Street, Suite 412
 New Brunswick, NJ 08901
 P: 609- 651-1352
 F: 732-418-9140
www.vertices.com www.gis4kids.com

Our mission at VERTICES is to provide affordable and effective map-based solutions and tools. VERTICES is a strong proponent of utilizing Open Source GIS (e.g. MapServer & PostgreSQL) and OpenMap APIs (e.g. Google Maps API) to deliver our various mapping options to a diverse range of organizations. VERTICES is especially committed to providing PPGIS tools for communities with little or no GIS knowledge. Please explore our website to see how we can help your organization utilize interactive mapping technology.

Booth 316**Booth 405****Yotta MVS**

1601 Iron Street Suite 101
 North Kansas City, MO 64116
 846-842-1010
www.yottamvs.com

Yotta MVS, Inc., formerly Mobile Video Services, specializes in field data verification. Yotta MVS partners with local governments to field verify and geo-audit land records; parcel layer, street centerline, and site address, flagging exceptions while in the field collecting high resolution street-view images. The deliverables include a MapObjects application that allows users to identify and resolve exceptions at the desktop, or download exceptions to a tablet and use the application as a map routing tool in the field.

Booth 416

EXHIBIT HALL FLOOR PLAN

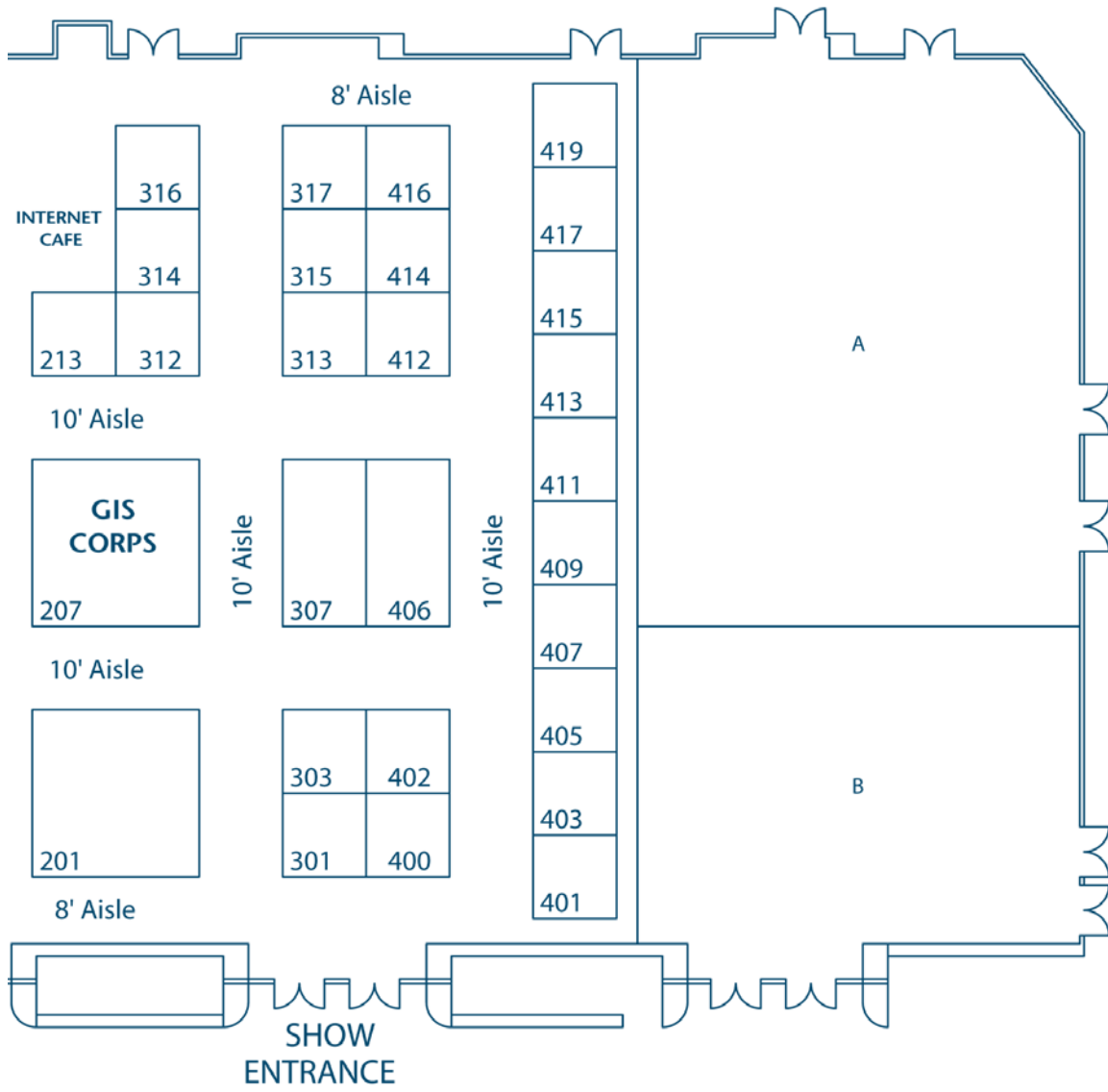

SHERATON NEW ORLEANS FLOORPLANS

Fourth Floor

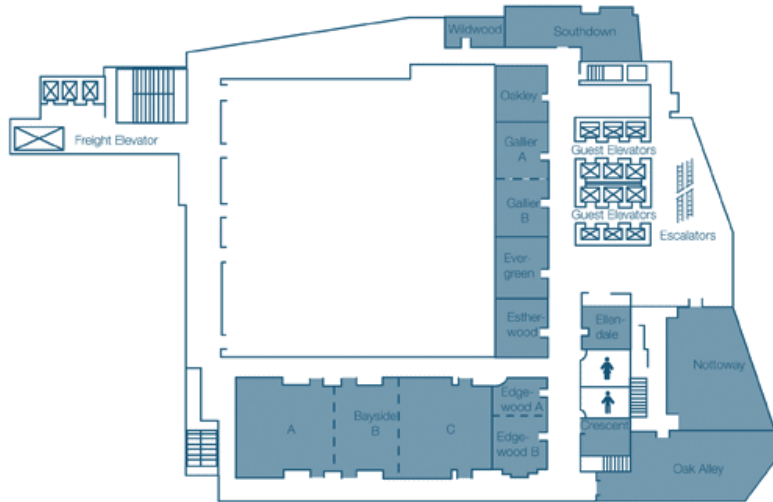

Fifth Floor

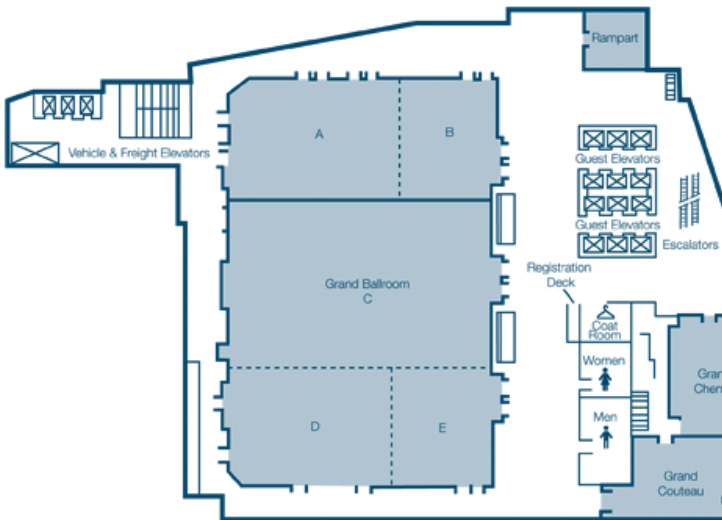

Eighth Floor

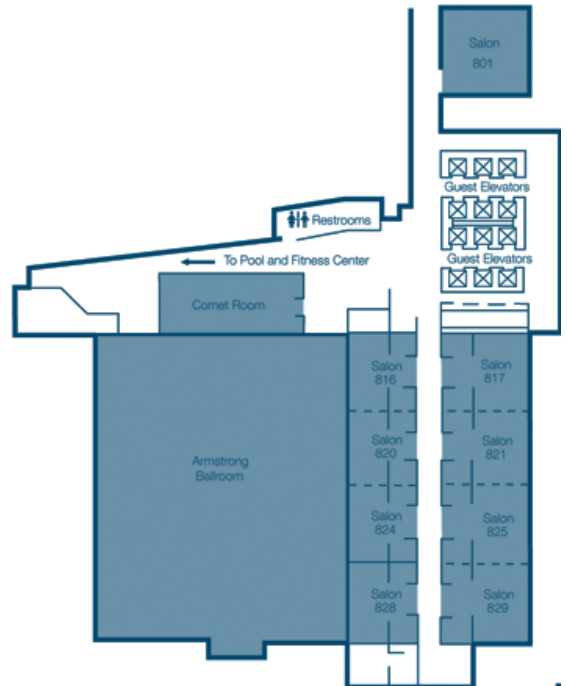

SPEAKER INDEX

Adams, Doug	15	Gullett, Tamarin.....	20	Paquin, Marc Andre	31
Adkins, Malcolm.....	24	Gutierrez, Alan.....	34	Pattison, Tom.....	16
Allen, David.....	28, 33	Haley, Dianne	25	Payne, Anne.....	31
Amadori, Jason.....	15, 21, 31	Hartsfield, Lee.....	26	Peng, Helen.....	21
Amanna, Richard	33	Hawker, Dave	31	Perdu, Erin	19
Anderson, Carl	15, 26, 32	Heckert, Megan.....	24	Perkins, Hilary	21, 32
Aquila, Bruce	30	Hoffman, Ken	19	Pettit, Christopher	18
Arciniegas, Gustavo	19	Hu , Tim	30	Ponte, Tom	33
Arctur, David.....	15	Hunter, Gary	28	Posner, Jonathan	29
Avnayim, April	28	Ibaugh, Allen.....	15, 28, 31	Poulter, Harry	31
Ayan, Danielle.....	18, 26	Im, Wansoo	19, 24, 30, 31	Pylar, Allison	29
Babinski, Greg.....	16, 19	Ioup, Elias.....	33	Raber, Brian.....	16
Baranowski, Andrew.....	15	Jacoby, Doug.....	16	Ramasubramanian, Laxmi.....	16, 33
Beck, Stephen	26	Jain, Dharmesh.....	27	Reilley, Robin.....	34
Bitters, Barry	29	Joffe, Bruce.....	25, 27	Rifkin, Drew	24
Bohard, Eric.....	20, 27	Johnson, Chris	19	Riordan, Scott	20
Bohn, Jim.....	20	Johnson, Craig	21	Ritchie, Wendy.....	29, 30
Boivin, Michelle.....	28	Johnson, Joseph Olakunle	24	Rogers, Cory	15
Bonaguro, Joy	29	Jones, Brent	34	Ross, Lutz.....	19
Bossard, Earl	30	Jordan, Winchester	24, 31	Roy, Manoj Kumar	30
Bruce, Ingrid	31, 33	Kalinski, Art.....	26, 28	Ruiz, Marilyn	30
Buckner, Rhonda.....	30	Kaunda, Nalishebo.....	34	Saarinen, Justin	26
Bury, Greg.....	24	Kinzy, Stephen.....	29	Salling, Mark.....	24, 25
Butler, Al.....	25, 33	Knauer, Josh	33	Sato, Kevin.....	33
Campbell, Bill	30	Krejcarek, Randal	15	Schlosser, Michael	24, 28
Canete-Medina, Isabel.....	32	Kron, Warren.....	24	Schorling, Craig	30
Carolan, James.....	15	Krusemark, Matthew	25	Seo, Hyunji	34
Chang, Hoon	34	Kwiedorowicz, Darius.....	28	Sharp, Stephen	28
Chong, Kyusoo	34	LaBranche, David.....	29	Shin, Sharon	28
Christman, Scott	33	Laird, Jeffrey	28	Smith, Cy.....	26, 34
Colby-George, Judy	16	Lanter, Dave.....	15	Somers, Rebecca.....	16, 29
Comeaux, Conrad.....	24	Lebo, Kurt.....	27	Sperling, Jon.....	18
Conry, Tom	28	Lopez, Xavier.....	21	Stewart, Karen	16, 28
Cragg, Ryan.....	24	Lovett, Mike	21	Syversen, William.....	33
Craig, Will.....	18	Lwin, Ko Ko	30	Tang, U Wa.....	29
Croswell, Peter	16	Lyon, Mark.....	20	Thomas, Chris	21
Curry, Mark.....	32	Mac Donald, Marianne	19	Thomas, Phyllis.....	26
DiBiase, David	33	Maheshwari, Sudha	24, 34	Tremaine, Stephen	34
Dombrowski, Alain.....	28	Matta, Rogelio	27	Trudnak, Jeffrey.....	24
Dunwoody, Garrett	30	Mc Donough, Kim	25, 28, 29	Tsui, Mary	16
Dupont, Lynn	21	McCarthy, Deidre.....	28	Tulloch, David	31
Elhami, Shoreh	18, 25	Melero, Ken.....	30	Villalobos, Jose	24
Field, Joe	27	Mills, Jacqueline.....	30	von Meyer, Nancy.....	31
Finigan, John.....	33	Mitchell, Brant.....	19	Warren Ross, Denice	34
Fournier, Keith	28, 29	Mitchell, Gilbert.....	20	Wayne, Lynda.....	28
Garie, Hank.....	30	Monzon, Juan Pablo	28	Wells, Ed	16
Gibson, Dr. David	27	Morteo, Jorge.....	19	Wells, Martha	15, 32
Gilbrook, Michael	24	Moyer, D. David	20	Wierzbinski, Mike.....	30
Gisclair, David.....	18, 21	Murray, David.....	19	Wong, Previn	30
Goldberg, Daniel.....	30	Obremski, Mark.....	44	Woo, Jeyoon	34
Gough, Justin.....	28	Oliver, Tim.....	18	Yurman, Sara	15, 20, 32
Greene, David	24	Ortiz, Elaine.....	29		
Guan, Wendy.....	21	Owen, Peter	19		

MARK YOUR CALENDAR!



**URISA's 47th
Annual Conference &
Exposition**

**September 29–October 2, 2009
Anaheim, CA**





Extend your GIS Across the Enterprise.

Share the value of your work throughout your organization with Server GIS.

As a geographic information system (GIS) professional, you receive countless requests for maps and spatial information. Answering special requests, while important, takes time and reduces your productivity.

Imagine being able to push your maps, models, and tools out to the rest of the organization via focused, easy-to-use applications. Staff in other departments and out in the field

could query accurate, up-to-date data without a lot of training. This increases their productivity as well as yours.

By making your maps, data, and analyses readily available, you can help others reap the benefits of the GIS work that you do. You already know that spatial analysis and visualization are important parts of daily decision making. Use Server GIS from ESRI to help others benefit from your work.

"The server-based options provided by ESRI allow the City of Mesa to deliver more enterprise GIS applications throughout our organization without high installation and training costs."

Jason Bell
IT Services Leader,
City of Mesa, Arizona

To learn how organizations are using ESRI server GIS to improve productivity, visit www.esri.com/server.

In the United States: 1-866-447-3036
Outside the United States: +1-909-793-2853, extension 1-1235
On the Web: www.esri.com/international

